

Discovery®  
FLEETWOOD RV



2004



In 1804 Lewis and Clark set out on a voyage  
of Discovery like no other.

Relive the **DISCOVERY** of a lifetime.



# SEEK

In 1804 Lewis and Clark set out on a patriotic venture to discover the uncharted West. They forged ahead encountering firsthand the marvel of the world beyond known borders. The natural wonder that spilled forth from their journey—majestic mountains, unbroken swaths of dense emerald forest, snaking rivers and mighty towering falls fueled imaginations, filling journals and ultimately history books.

Centuries have passed but Lewis and Clark's pioneering spirit lives on in every American—the desire to move forward, transcend the ordinary embracing freedom at every step. Today Discovery is your guide to exploring new territory and enjoying the unspoiled beauty of America and beyond. For more information on the Lewis and Clark trail please visit: [www.lewisandclark.org](http://www.lewisandclark.org)

## CONTENTS



- p. 2-4 — LIVING AREA OVERVIEW
- p. 5-6 — BEDROOM+EXTERIOR OVERVIEW
- p. 7-8 — TECHNICAL OVERVIEW



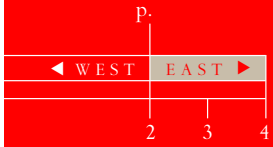



# E X P L O R E

You'll be navigating the highways, byways, routes and roads of our great land in the luxury you've come to associate with Discovery. Features such as an ergonomically enhanced dash accentuate a center console with easy to reach snack tray; and our exclusive Rear Vision Camera deliver precision and control ensuring your continuous safety and comfort.

Enjoy dramatic vistas of the open road from your windows and five star dining made simple with convection microwave, side-by-side refrigerator and gourmet galley replete with solid surface counter tops and sink, rich finished cabinets and sophisticated black chrome accents. You'll find new "smart" storage options including kitchen pull out with wastebasket, cover storage and basket; a spacious pantry with slide out storage and dinette bins with locks for improved space utilization and convenience. Home is wherever you are with grand touches such as a \*bedroom residential window seat, and optional washer/dryer.

\*N/A to all models (floorplans)



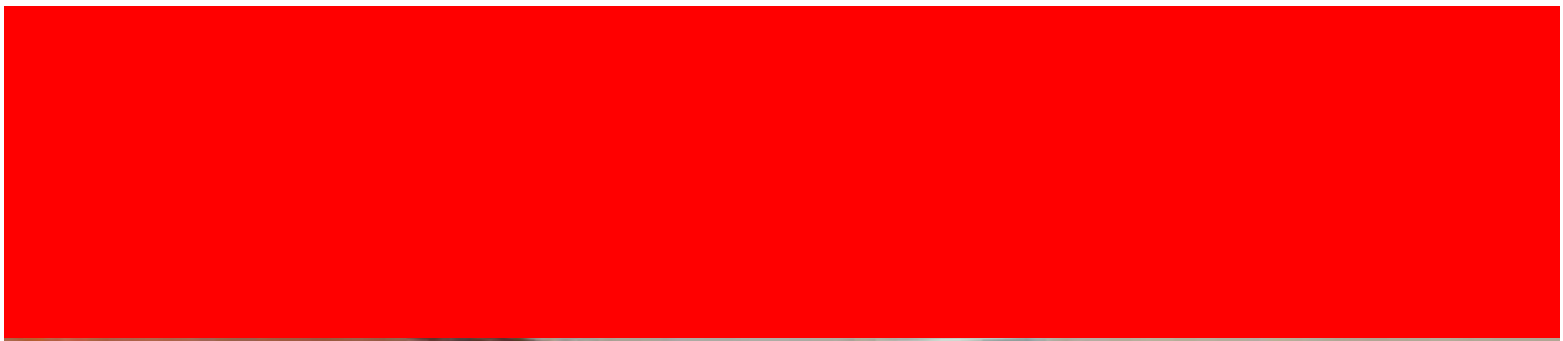



# DISCOVER

Discovery's true mark of distinction lies in its details—smart storage and solid surface sink, in the sky lit lavatory; ambient décor lighting, nightstand storage and queen size pillow-top bed in rich fabrics in the bedroom; wire shelving, black chrome hardware and showcase alcove in the cedar-lined wardrobe—Discovery's quality and refinement are undeniable. For the ultimate adventurer Discovery offers a bedroom \*home theatre entertainment unit, \*residential window seat, \*fireplace with 32" television and desk for that added touch of home away from home.

Lewis and Clark's quest stretched nearly four years, but they didn't have the benefit of Discovery's commanding 330 hp Caterpillar® diesel engine, Freightliner® Chassis for smooth navigability, nimble response and an overall glorious ride. Discovery's graphically striking exterior features full body paint and color-coordinated TPO™ roof. Discovery embraces the concept of "smart" storage all around with a generous \*\*spare tire compartment, insulated aluminum luggage doors, seamless stainless steel latch rods and rotomolded compartments. The multifaceted Discovery also features the signature EZ Glide™ slide out system expanding your living space with the touch of a button. Broaden your perspective with Discovery's latest additions: optional chrome side mirrors with bi-view feature, delivering two different views for optimum visibility and a middle side marker light with turn signal make your safety a priority.

\*N/A to all models (floorplans)

\*\*Tire supplied by customer



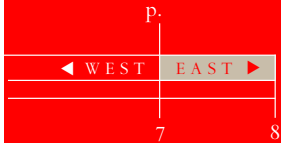

## \*STRUCTURE



- 1 Royal Tuff-Ply™ TPO Crowned Roof
- 2 In-Ceiling Ducted Roof Air Conditioning
- 3 Interlocking, Lightweight Aluminum Framing
- 4 Fleetwood's Exclusive Power Platform™
- 5 Full Paint Exterior
- 6 Lightweight Foam Insulation
- 7 Fleetwood's Vacu-Bond™ Roof, Floor & Sidewalls



\*Drawings are for illustrative purpose only to highlight aspects of Motor Home construction. Actual motor home design depends on model and is subject to change.

## STRIVE

In the continuing tradition of America's first road trip, it takes vision to start a journey and commitment to complete one. A recreational vehicle of Discovery's caliber begins with quality, craftsmanship and commitment. From the materials we use to the finishes we offer; the individuals we employ to the services we provide—we continuously emphasize our business philosophy of **Size, Service and Quality equals Value (SSQV)**.

Pride of ownership rests with the freedom to customize and appoint your home according to your sensibility. We recognize the satisfaction of making something your own, which is why we offer the greatest variety and highest quality in finishes, fabrics and exterior paints. Your home reflects your unique taste and individuality, why shouldn't your home away from home do the same?

In being the world's number one RV manufacturer we feel a greater need to be accessible which is why you'll find Fleetwood facilities all across America. Service means supporting and listening to our customers seven days a week and going the extra mile in providing Ownercare, one of the RV industry's most comprehensive programs which includes systems and applications, construction, no deductible and no service charge. Our definition of Quality doesn't waver with time but means the same thing it always has—exceptional production from start to finish. Value equals peace of mind and precision manufacturing that's priced right with style. Together, these qualities equate the very best RV you can buy. Welcome to Fleetwood. When does your Discovery begin?



EXTERIOR | INTERIOR  
OPTIONS

Cherry

Windsor Birch

Fairfield Maple



LA QUINTA



SEDONA



STONEHENGE





**RV OWNERCARE** is a limited one-year/three-year or 15,000 mile warranty, whichever occurs first, and it is fully transferable for the first 12 months. RV Ownercare is one of the RV industry's most comprehensive programs and includes systems, appliances, components, and construction, with no deductible and no service charge. RV Ownercare coverage is provided from a company that will be around in the future to service your needs. See your nearest Fleetwood dealer for a full explanation of benefits and restrictions.

**Important—Please Read:** Product information, photography and illustrations included in this publication were as accurate as possible at the time of printing. For further product information and changes, please visit our website at [www.fleetwoodrv.com](http://www.fleetwoodrv.com) or contact your local Fleetwood dealer.

Prices, materials, design and specifications are subject to change without notice. All weights, fuel, liquid capacities and dimensions are approximate. Fleetwood has designed its recreational vehicles to provide a variety of uses for its customers. Each vehicle features optimal seating, sleeping, storage and fluid capacities. The user is responsible for selecting the proper combination of loads (i.e. occupants, equipment, fluids, cargo, etc.) to ensure that the vehicle's capacities are not exceeded.



**JOIN A CLUB TODAY!!**

[www.clubfleetwood.com](http://www.clubfleetwood.com)

**Discovery Owners Association**

[www.discoveryowners.com](http://www.discoveryowners.com)

**Discovery International of FMCA**

[www.geocities.com/difmca/](http://www.geocities.com/difmca/)

**IDMC, Internet Discovery Motorhome Club**

[www.discoveryrvclub.org](http://www.discoveryrvclub.org)

Your Local Fleetwood RV Dealer is:

Visit our website to find a dealer near you or learn more about other Fleetwood products:

**[www.fleetwoodrv.com](http://www.fleetwoodrv.com)**  
or call 1-800-444-4905.



2004

**Explore Discovery's Features and Benefits.**

**Storage all the way around!** — Gives you the ability to organize and distribute your load while maximizing all of the available storage space.

**Full Paint Exterior** — Tremendous curb appeal and high line styling that is easy to maintain.

**Fully Automatic 4 Point Leveling System** — Unlike some competitors, you get to choose. Pick between a simple one button push operation and a do it yourself manual over ride.

**Flexsteel Furniture Standard with Ultra leather (Optional)** — Comfortable and easy to clean, built by a well-known name brand furniture expert with a limited lifetime warranty.

**Laminate Tile Entry Landing, Standard** — High-pressure laminate is easy to clean with a damp mop and is scuff resistant to keep your coach entry-way looking good.

**Dinette Table for 6** — This extendable dinette is perfect for those times you have a few more guests or just need extra space. Table pulls out and comes with a leaf insert and 2 folding chairs. (Available on select models.)

**10,000 lb. Hitch Receiver\*** — Large capacity hitch receiver gives you more choices in the vehicle or "toys" you want to haul.

**Home Theater Sound System, Standard** — Just like being at the movies, this 5.1 surround system also plays DVD's, CDs and MP3 formats, plus AM/FM Stereo. Giving you one more reason to stay out on the road a little while longer.

**By Fleetwood** — a name you know, a name you trust.

## Model 35M

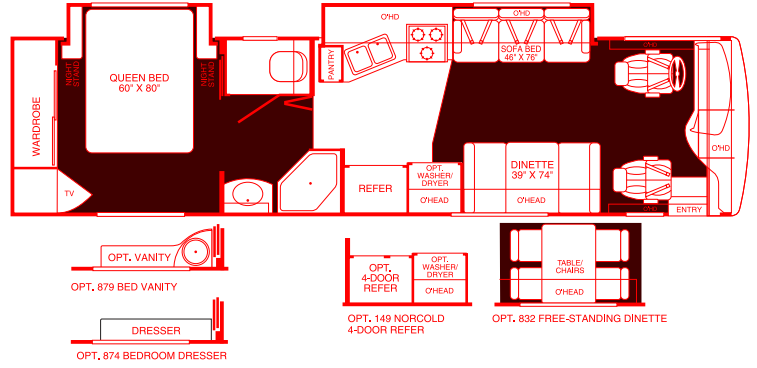

## Model 38U

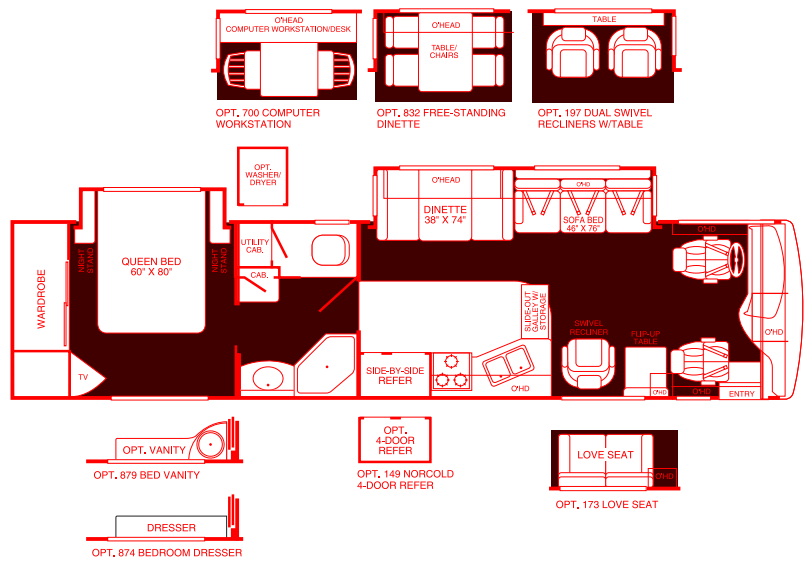

## Model 39A

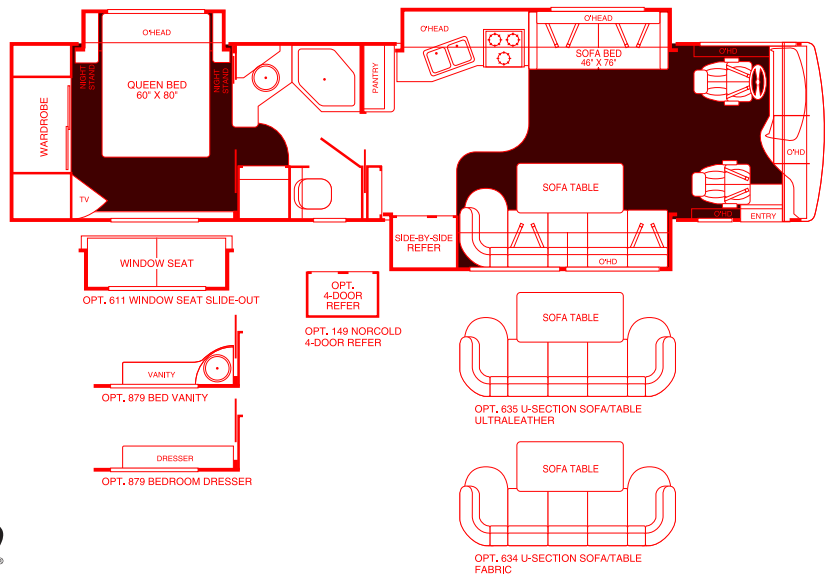

# Model 39B



OPT. 700 COMPUTER WORKSTATION    OPT. 832 FREE-STANDING DINETTE    OPT. 197 DUAL SWIVEL RECLINERS W/TABLE    OPT. 202 SOFA SLEEPER

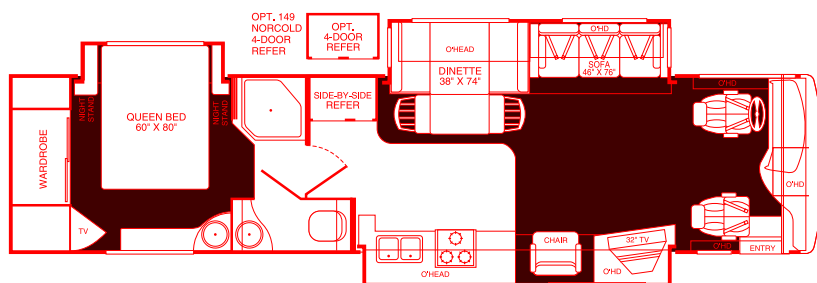

OPT. 700 COMPUTER WORKSTATION    OPT. 832 FREE-STANDING DINETTE    OPT. 197 DUAL SWIVEL RECLINERS W/TABLE    OPT. 202 SOFA SLEEPER

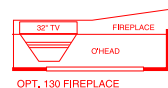

OPT. 130 FIREPLACE

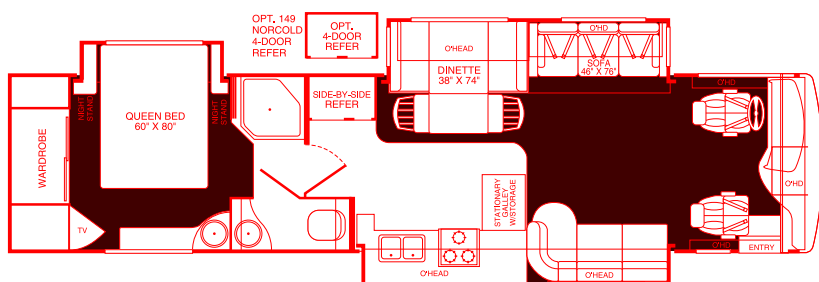

# Model 39J



OPT. 700 COMPUTER WORKSTATION    OPT. 832 FREE-STANDING DINETTE    OPT. 197 DUAL SWIVEL RECLINERS W/TABLE    OPT. 202 SOFA SLEEPER

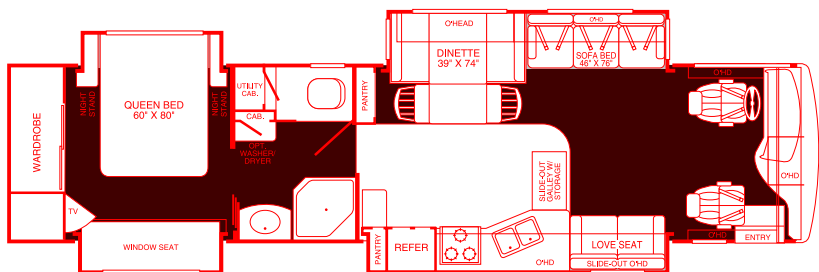

# Model 39L



OPT. 357 SLIDE-OUT BEDROOM ENTERTAINMENT CENTER



OPT. 149 NORCOLD 4-DOOR REFER



OPT. 700 COMPUTER WORKSTATION    OPT. 832 FREE-STANDING DINETTE    OPT. 197 DUAL SWIVEL RECLINERS W/TABLE    OPT. 202 SOFA SLEEPER

# Model 39S

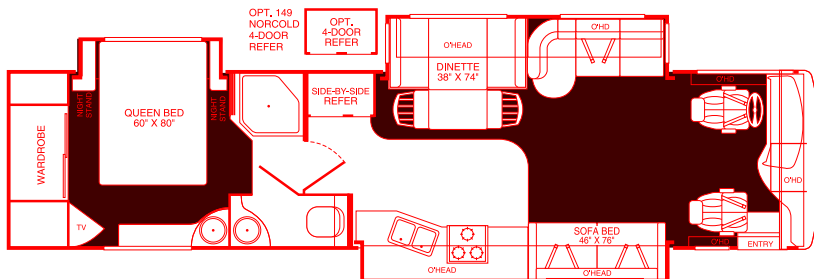

OPT. 809 SOFA SLEEPER

# Standard Features

## Appliances

- Front 27" Panasonic® Stereo TV in Overhead (Model 39B - 32")
- Rear 20" Panasonic® TV
- Panasonic 5 Disc DVD Home Theater Sound System
- Hi-Fi VCR
- Smoke Detector/Alarm
- LP Gas Detector/Alarm
- CO Detector/Alarm
- 20,000 BTU/25,000 (Dual) Furnace
- 32,000 BTU (35M Model Only)
- 10-Gallon, Quick-Recovery Water Heater with D.S.I. (Gas/Electric)
- 3-Burner, High-Output Cooktop w/Sealed Burners
- Light/Power Range Hood (Integrated into Microwave)
- Monitor Panel in Front Overhead
- Solid Surface Range Cover
- Dual Roof A/C High Efficiency w/Solar Panel on Front A/C
- Water Heater Bypass System
- Porcelain Toilet with Water Saver
- Toilet Tank San-T-Flush™ System
- 1.4-cu. ft. GE® Convection Microwave
- 12-cu. ft. Side-by-Side Dometic® Refrigerator
- Single-Lever Galley Faucet with Retractable Wand
- Water Filter with Faucet
- Demand Water Pump with Filter
- TV Antenna
- Fan-Tastic® Power Roof Vent—Galley and Bath
- Fire Extinguisher
- Telephone Jack in Living Area and Bedroom
- Rear Speakers in Bedroom
- Coffee Maker
- Bedroom Radio
- Body Structure
- Vacu-Bond® Upper/Lower Floors
- Vacu-Bond® Walls with Smooth High-Gloss Exterior Fiberglass
- Radius Roof with Ducted A/C
- Royal Tuff-Ply™ Roof
- Aluminum Interlocking Floor/Wall/Ceiling Framing

## Electrical

- Doorside Patio Receptacle
- 120V/12V AC/DC Converter with 2000-Watt Inverter
- Central Electrical Panel
- 120V/12V Wire Raceways
- 3-Way Water Pump Switch
- 7.5kW Onan® Quiet Diesel Generator
- 50-amp Service
- Wall Switches
- EMS—Energy Management System
- Four 6V/Deep-Cycle 218-amp House Batteries

## Exterior

- Full Body Paint
- Fiberglass Front/Rear Cap
- Fiberglass Front Quarter Panels
- Fiberglass Rear Wheel Well Trim
- Aerodynamic Styling
- Roof Mounted Chrome Air Horns
- DSS Satellite Dish (Manual)
- Entry Door with Deadbolt Latch
- Slider Windows
- Torque Windows in Bedroom
- Utility Compartment with Exterior Shower
- 4-Point Automatic Hydraulic Levelers
- Roof Ladder
- Lighted Exterior Entry Assist Handle
- Remote Heated Rear View Mirrors
- 20' Sewer Hose

- Park Cable Receptacle
- Awning Rail/Drip Molding (Both Sides)
- Power Entry Step
- Dual Battery Charge Control
- Porch Light
- 3 Colorway Graphics to Match Decor
- Manual Patio and Entry Awning

## Exterior Automotive

- Large, Aerodynamic Bonded in Windshield
- Undercoating
- Aluminum Wheels
- Valve Extenders
- Underhood Utility Light
- Steel Surface on Bulkhead
- Trailer Hitch with 7-Point Electrical Hook-Up\*
- Large Headlamps with Turn Signal
- Rear Vision Camera
- Single Motor Windshield Wipers with Wet Arm
- Mud Flaps
- Fog Lamps
- Freightliner® Chassis
- 330 HP Caterpillar® Engine

## Exterior Storage

- Insulated Aluminum Luggage Doors
- Single-Paddle/Metal Latches
- Continuous One-Piece Bulb Seal
- Hidden, Stainless Steel Latch Rods
- Hidden Lift Strut Supports
- Lighted Compartments
- Roto-molded Compartments
- EZ Store™ on Slide-Outs
- Spare Tire Compartment (Tire Supplied by Customer)

## Interior

- 3 Interior Decors
- Skylight in Tub/Shower
- Glass Shower Door
- Printed Plush Wall-to-Wall Carpet w/Carpet Pad
- Wood Drawers
- Roller Guide Drawer Slides with Transit Ship Locks
- Cedar Lining in Wardrobe
- Radius Corner Cabinetry
- Coordinated Cabinet Hardware
- Residential Wire Shelves in Wardrobe
- Pleated Day/Night Shades
- Bedspread with Decor Pillows
- Lighted Entry Assist Handles
- Restonic® Pillow Top Innerspring Mattress
- Hardwood Cabinet Doors & Drawers
- Solid Surface Countertops in Galley & Lavy
- Crown Molding
- Laminate Floor Tile in Galley & Bath
- Beveled Mirrors
- Slide-Out Dinette Bins with Locks
- Hardwood Bath Door/Trims
- Wood Trim Table Tops (Dinette & Nightstands)
- Trash Basket in Galley
- Molded Tub/Shower
- Coordinated Bath Accessories
- Residential Seat Styling
- Hardwood Raised-Panel Cabinet Doors
- Adjustable Cabinet Shelves (Selected Cabinets)
- Sink Covers
- Solid Divider Doors
- Solid Surface Sink in Galley
- J-Lounge Sofa (Some Models)
- Solid Surface Lavy Sinks
- Bedroom Vanity with 2nd Sink (Some Models)

## Interior Automotive

- Intermittent Wiper Control
- Multi-Function Sun Visors
- Cruise Control

- AM/FM/CD w/Cassette Radio
- Auxiliary Start Circuit
- Battery Shut-Off Switch
- Auto A/C Heater Combo
- Radio Switch—Main/Auxiliary Power
- Soft-Surface Automotive Dash
- Driver/Passenger Captain's Chairs with Reclining Back/Slide Controls
- Dash Fans
- Tilt/Telescoping Steering Wheel
- 3-Point Seat Belts on Driver/Passenger Seats

## Interior Lighting

- Wardrobe Lighting
- Fluorescent Lighting
- Decor Lighting
- Incandescent Lighting
- Wall Sconces
- Make-Up Lights in Bath (Some Models)
- Bedroom Lighting
- Lighted Assist Handle in Lavy

## Platform Construction

- Basement Floor Configuration
- Heated Water & Holding Tank Compartments
- Polyethylene Luggage Compartment Boxes
- Power Platform
- Coach Vibration Isolators

\*The chassis manufacturer recommends the installation of a supplemental brake control system to activate the brakes on the vehicle or trailer you are towing.

# Options

## Appliances

- 3-Burner Range with Oven
- Washer/Dryer
- Central Vacuum system
- DSS Auto Locating/Satellite Dish (Covered)
- Norcold® 4-Door Refrigerator with Ice Maker

## Electrical

- CSA Package

## Exterior

- Awning—USA (Power)
- Front Mask
- Spotlight with Remote Control
- Chrome Exterior Mirrors
- Keyless Entry

## Interior Automotive

- Stereo AM/FM with 6 Disc CD

## Interior

- Ultraleather™ J-Lounge Sofa (N/A on Models 35M, 39B & 39L)
- Ultraleather™ Sofa Bed
- Ultraleather™ Sofa Sleeper (N/A on Model 35M & 39A)
- Free-Standing Ultraleather™ Swivel Recliner (38U & 39L Only) (N/A on Models 35M, 39B, 39J & 39S)
- Ultraleather™ Passenger Seat with Power Foot Rest
- Ultraleather™ Love Seat (Model 38U & 39L Only)
- Free-Standing-Dinette with Chairs (N/A 39A)
- Computer Workstation at Dinette (N/A on Model 35M or 39A)
- 3-Burner Sealed Drop-In Range with Oven
- Power Sun Visors
- Bedroom Vanity with 2nd Sink (N/A on Model 39L)
- Ultraleather™ Dual Free-Standing Recliners (N/A on Models 35M)
- Dual A/C w/Heat Pump
- Bedroom Dresser (Models 35M, 38U & 39A)
- Bedroom Vanity (Models 35M, 38U & 39A)
- Bedroom Entertainment Center (Model 39L Only)
- Bedroom Window Seat Slideout (Model 39A Only)

Freightliner® Chassis	35M	38U	39A	39B	39J	39L	39S
Engine Liters	7.2L	7.2L	7.2L	7.2L	7.2L	7.2L	7.2L
Wheelbase	208"	242"	252"	252"	252"	252"	252"
GVWR (lbs) (1)	27,910	27,910	27,910	27,910	27,910	27,910	27,910
Front GAWR (lbs) (2)	10,410	10,410	10,410	10,410	10,410	10,410	10,410
Rear GAWR (lbs) (2)	17,500	17,500	17,500	17,500	17,500	17,500	17,500
Base Weight (lbs) (3)	21,255	21,555	22,605	22,605	22,605	22,900	22,605
GCWR (lbs) (4)	37,910	37,910	37,910	37,910	37,910	37,910	37,910
Hitch Rating (lbs)*	10,000	10,000	10,000	10,000	10,000	10,000	10,000
Tongue Weight (lbs)*	1,000	1,000	1,000	1,000	1,000	1,000	1,000
Fuel Capacity (gal)	90	90	90	90	90	90	90
<b>Dimensions and Capacities</b>							
Overall Length (5)	35' 4"	38' 2"	39' 0"	39' 0"	39' 0"	39' 0"	39' 0"
Overall Height (with A/C)	12' 3"	12' 3"	12' 3"	12' 3"	12' 3"	12' 3"	12' 3"
Overall Width (maximum) (6)	102"	102"	102"	102"	102"	102"	102"
Interior Height (maximum)	79"	79"	79"	79"	79"	79"	79"
Interior Width (maximum)	96"	96"	96"	96"	96"	96"	96"
Fresh Water Holding Tank (gal)	86	86	86	86	86	86	86
Grey Water Holding Tank (gal)	50	50	50	50	50	50	50
Black Water Holding Tank (gal)	50	50	50	50	50	50	50
Appliance LPG Tank (gal) (WC) (7)	38	38	38	38	38	38	37
Water Heater Tank (gal)	10	10	10	10	10	10	10

**Liquid Weight Reference:** Water (gal) = (8.3 lbs/3.8 kgs) Fuel (gal) = (7.1 lbs/3.2 kgs) LPG (gal) = (4.2 lbs/1.9 kgs)

**Metric Conversion:** Multiply pounds x 0.453 to obtain kilograms Multiply gallons x 3.785 to obtain liters

1. GVWR (Gross Vehicle Weight Rating): Means the maximum permissible loaded weight of the motor home. The GVWR is equal to or greater than the sum of the unloaded vehicle weight plus the net carrying capacity.
  2. GAWR (Gross Axle Weight Rating): Means the maximum permissible loaded weight a specific axle is designed to carry.
  3. Base Weight: Means the estimated weight of the motor home without fuel, options, water, cargo or passengers.
  4. GCWR (Gross Combined Weight Rating): Means the value specified by the motor home manufacturer as the maximum allowable loaded weight of this motor home with its towed vehicle. Towing and braking capacities may differ. Refer to Fleetwood and chassis manufacturer manuals for complete information.
  5. Length taken from front bumper to rear bumper (excludes accessories).
  6. Excludes safety equipment and awnings.
  7. Tank Manufacturer's listed water capacity (WC). Actual LPG capacity is 80% of water listing as required by the safety code.
- \* The chassis manufacturer recommends the installation of a supplemental brake control system to activate the brakes on the vehicle or trailer you are towing.

**IMPORTANT — PLEASE READ:** Product information, photography and illustrations included in this publication were as accurate as possible at the time of printing. For further product information and changes, please visit our website at [www.fleetwoodrv.com](http://www.fleetwoodrv.com) or contact your local Fleetwood dealer. Prices, materials, design and specifications are subject to change without notice. All weights, fuel, liquid capacities and dimensions are approximate. Fleetwood has designed its recreational vehicles to provide a variety of uses for its customers. Each vehicle features optimal seating, sleeping, storage and fluid capacities. The user is responsible for selecting the proper combination of loads (i.e. occupants, equipment, fluids, cargo, etc.) to ensure that the vehicle's capacities are not exceeded.



## RV OWNERCARE...

is a limited one-year/three-year or 15,000 mile warranty, whichever occurs first, and it is fully transferable for the first 12 months.



**RV OWNERCARE** is one of the RV industry's most comprehensive programs and includes systems, appliances, components, and construction, with no deductible and no service charge.

**RV OWNERCARE** coverage is provided from a company that will be around in the future to service your needs. See your nearest Fleetwood dealer for a full explanation of benefits and restrictions.

## Club Fleetwood...

As a Fleetwood owner, you're eligible to become a member of our owners group, Club Fleetwood. It's a perfect way to meet other Fleetwood owners who love to travel to beautiful resorts and vacation spots all across America. Call (877) 577-2560 and join the fun!



## What Drives You?

Maybe it's feeling like you're the only one on Earth. Perhaps it's the unique sense of closeness with the great outdoors. Or, it might be the joy that comes from spending quality time with family and friends.

Whatever the reason, we know that you have a strong drive to experience everything that comes with spending time on the road. And for more than 50 years, we've shared that passion with you.

Because we're RV enthusiasts ourselves, you can see our passion in the vehicles we design and build. Own a Fleetwood, and you'll feel like you're not just traveling, but embarking on an experience unlike any other.

Set your own course for adventure and get out there and explore the world around you. Once you do, you'll see what it is that drives us — it's you.



Your local Fleetwood dealer is:

[www.fleetwoodrv.com](http://www.fleetwoodrv.com) Visit our website to find a dealer near you or learn more about other Fleetwood products. Or call 1-800-444-4905.



**IMPORTANT—PLEASE READ:** Product information, photography and illustrations included in this publication were as accurate as possible at the time of printing. For further product information and changes, please visit our website at [www.fleetwoodrv.com](http://www.fleetwoodrv.com) or contact your local Fleetwood dealer. Prices, materials, design and specifications are subject to change without notice. All weights, fuel, liquid capacities and dimensions are approximate. Fleetwood has designed its recreational vehicles to provide a variety of uses for its customers. Each vehicle features optimal seating, sleeping, storage and fluid capacities. The user is responsible for selecting the proper combination of loads (i.e. occupants, equipment, fluids, cargo, etc.) to ensure that the vehicle's capacities are not exceeded.