

Montana™

"Built by People who know RVing"

2002



Reward
Yourself.

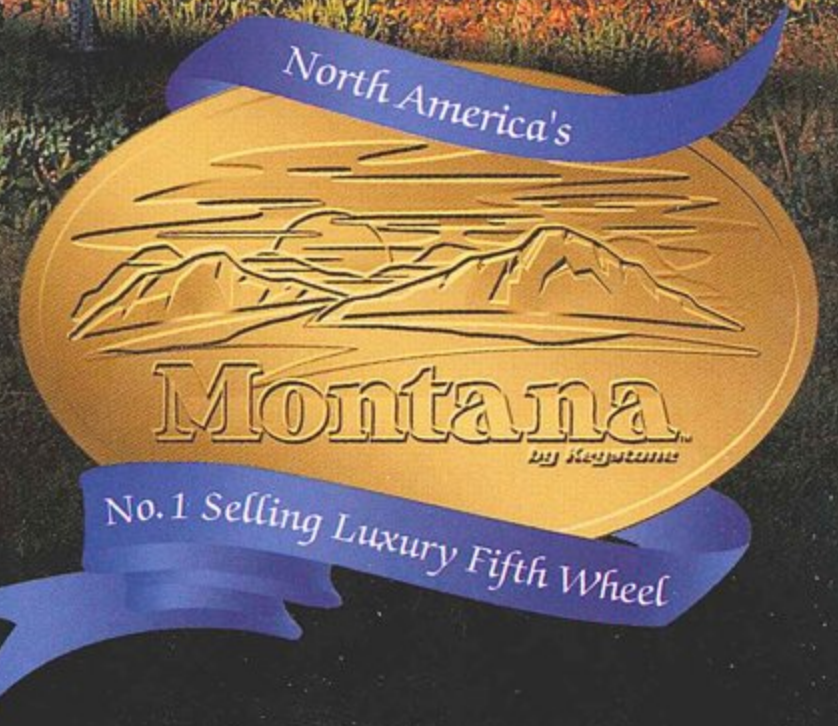



Montana's 3295RK triple slide-out floorplan features a step-saving, U-shaped kitchen and a convenient computer desk area. The Spring Floral color scheme is a soft backdrop for your own decorating touches.

Montana Quality.

Your first tour of a Montana will tell you—the quality you've been looking for is all there. Skilled craftsmen have combined Old World precision, New World technology and cutting-edge design to create a product experienced RVers can truly appreciate. "Attention to Detail" is evident throughout Montana—real wood moldings and door trim, steel drawer guides with roller bearings, solid oak doors and drawers and screwed cabinet fronts, for example. Throughout the Montana there is a level of "fit and finish" second to none. That is why the fifth wheel buyers of North America have made Montana the top-selling fifth wheel on the continent. When you are ready to reward yourself, move up to Montana.



Montana's 3280RL floorplan in Desert Sunset is shown looking toward the bedroom suite. At the bottom right, the same floorplan, viewing into the rear lounge.



The convenient pantry features a high-rise top shelf with pull-out drawers and a sliding waste container holder.

Montana Convenience.

Montana defines convenience. A good example is the kitchen area, where we've put into every feature to make your life easy and carefree. Residential size cabinets with Susans for instant access; white, easy-to-clean acrylic sinks with deep bowls and foot kicks under the lower cabinets; smooth drawer slides and even a knife holder built into the counter make meal preparation, serving and cleanup simple and fast. Generous lighting (for the living room/kitchen area) provides a splendid environment for reading and relaxing. Other carefully planned details throughout the Montana, many of which were suggested by our customers. We're proud to say that we listen and respond quickly.

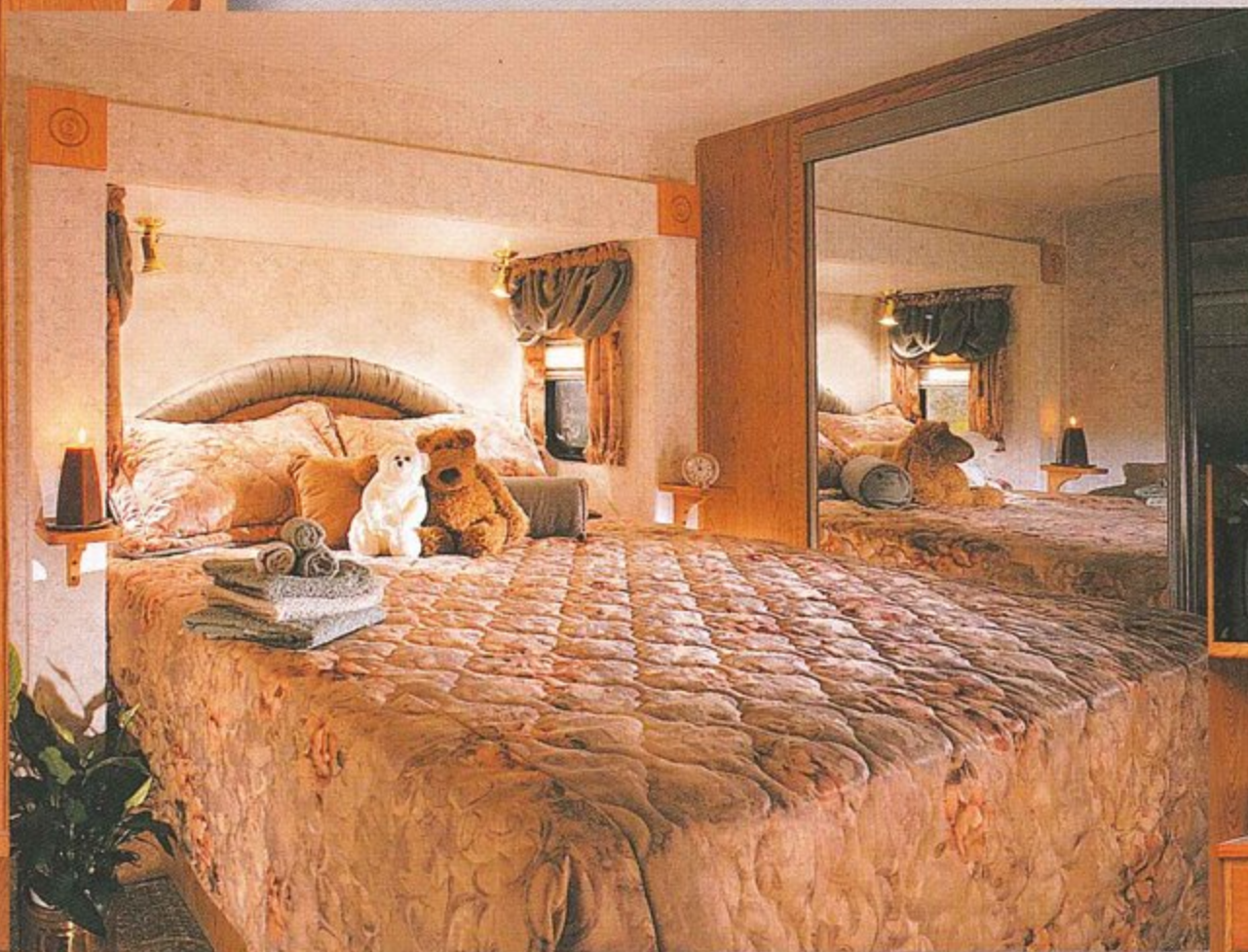

With bedroom slide room windows on the side walls, you can sit up and lean back to read or watch TV. Also, you'll have no worries about cold drafts near your head while you're sleeping.



The spacious triple dresser shown at right is a customer favorite.

Montana Comfort.

Premium-grade carpeting and upholstery, carefully coordinated room decor in three fashionable color schemes and luxurious lined draperies are all elements which add to Montana's residential comfort. Thoughtful touches like huge, fully vented windows, overhead cabinets in the extra-tall slide-out rooms and user-friendly appliances have been carefully planned by our staff of fifth wheel enthusiasts to make every hour you spend in the Montana enjoyable—truly carefree and completely relaxing.



designed efficiency
with touches like Lazy
high-arch faucets; toe
kick into the countertop
fifteen fixtures in the
kitchen. You'll find many
design suggestions straight from

Montana Construction.



Roof (R-14)*

1. One-Piece EPDM Rubber Roof Membrane with 12-Year Warranty
2. Aluminum Radius Roof Transition Molding
3. 3/8" Structurewood Roof Decking with 25-Year Warranty
4. 5" Welded Aluminum Truss Rafters on 16" Centers
5. Fiberglass Insulation
6. Ceiling Decking
7. Vinyl Ceiling
8. Insulated, Foam-Core Air Conditioning Duct
9. Attic Vent

Sidewalls (R-9)

10. Gel-Coated Filon™ Fiberglass
11. 1/8" Luan Board
12. Second Layer 1/8" Luan Board with Seams Staggered
13. Solid Block Foam
14. Interior Decorator Board
15. 2" Welded Aluminum Wall Studs
16. Electro-Galvanized Sheet (EGS) Metal Backing Strips
17. Radius Corner Blocks
18. Extended Hitchpin, 34' and Shorter

Floor (R-21)*

1. 10" Steel I-Beam
2. 3" Welded Aluminum Floor Joists on 16" Centers
3. 3" Large-Capacity Heat Duct
4. 1/4" ABS Underbelly
5. Astro-Foil Insulation (97% Heat Reflection)*
6. Full Radius Wrap Aluminum Enclosure
7. Moisture Barrier
8. Fiberglass Insulation
9. 5/8" Seamless, Structurewood Floor Decking with 25-Year Warranty
10. Carpet Pad
11. 28-Ounce Residential-Grade Carpeting with Stain Protectant
12. Aluminum Wheel Well
13. 2" Heat Duct from Furnace into Underbelly

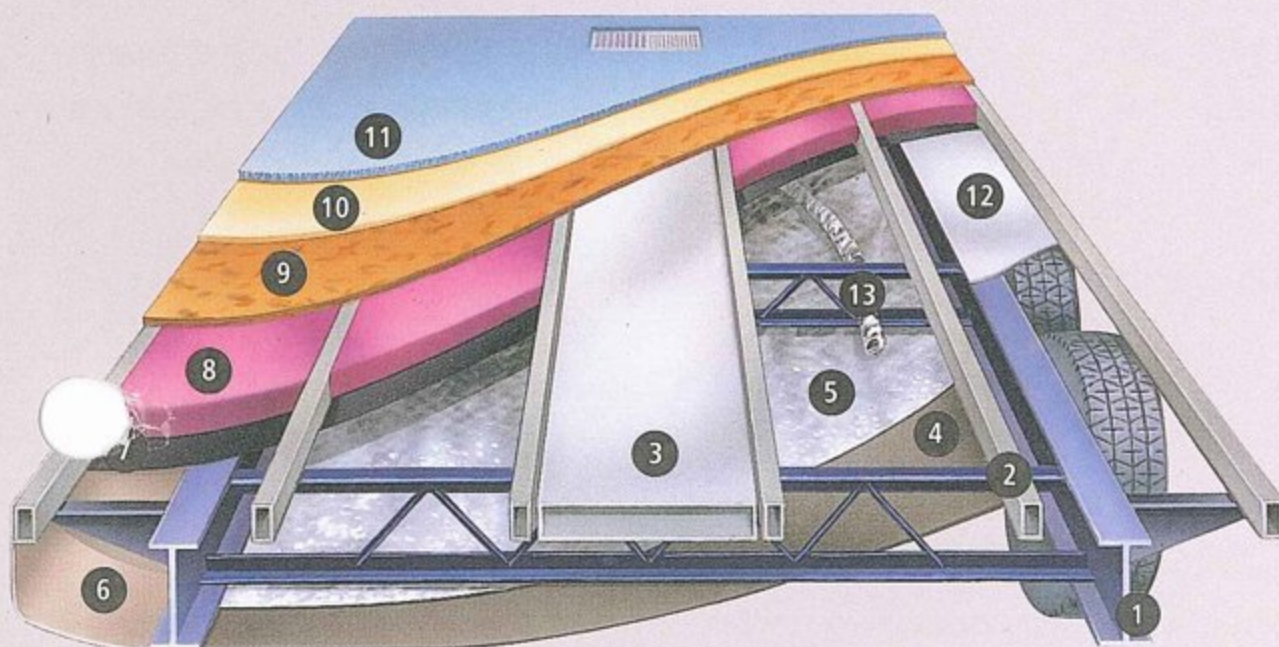

* When Equipped with "Arctic Insulation Package"

The Montana Story

When we began building Montana fifth wheels four years ago, our goal was to be the absolute best. By constantly looking for little ways to make the products perform better, Montana has continually evolved and improved.

Over the years, we have earned our customers' confidence, and I am proud to announce that Montana was recently honored as the top-selling fifth wheel in North America.

Our formula for this success has been straightforward. From the beginning, we have believed that our customers should have a large voice in our design, styling and features. We listen very closely to owner feedback and respond quickly. Further, we run our company with minimal "corporate overhead," allowing us to offer more features in the Montana than any comparable fifth wheel in the nation.

The results are seen every day among the thousands of happy Montana owners who travel along the highways of North America. On behalf of everyone at Montana, I hope you will enjoy our product as much as we have enjoyed creating it for you.

Sincerely,

R. F. ...
General Manager

Montana Interior Details.

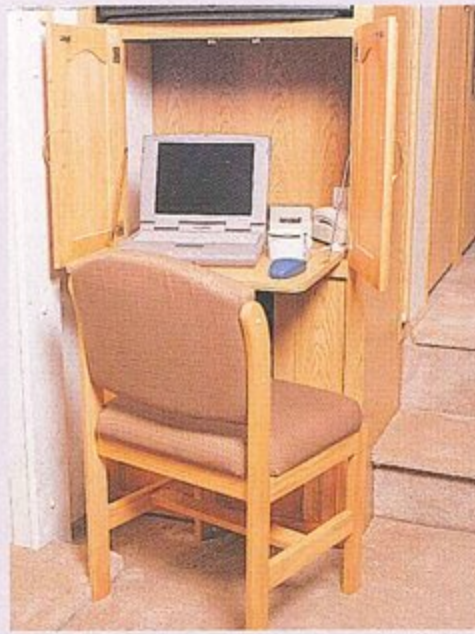

Your Montana computer center is built in, complete with a data port.



Montana's convenient Lazy Susan places food items at your fingertips.



All-wood moldings — you won't find plastic RV trim in a Montana.

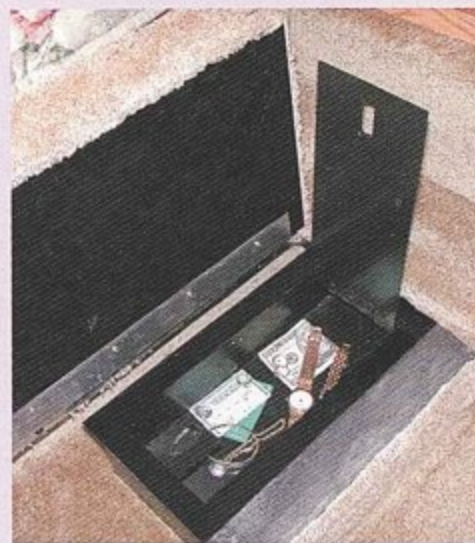

The hidden floor safe protects your valuables while you are away.



The no-fuss Freezeguard™ kit makes winterizing an easy, clean process.

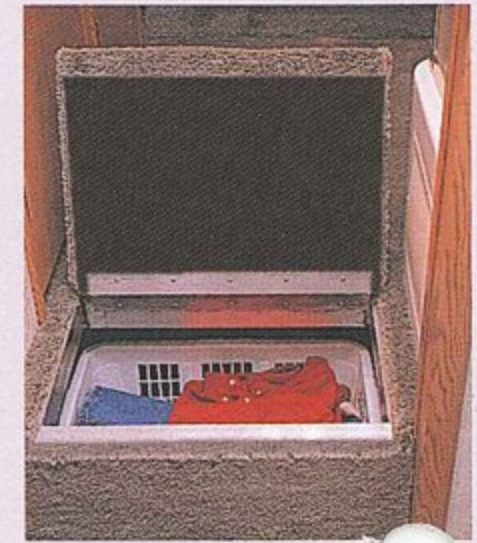

The easy-to-access laundry chute transfers dirty laundry into the outside storage area, away from your living space.

Montana Exterior Details.

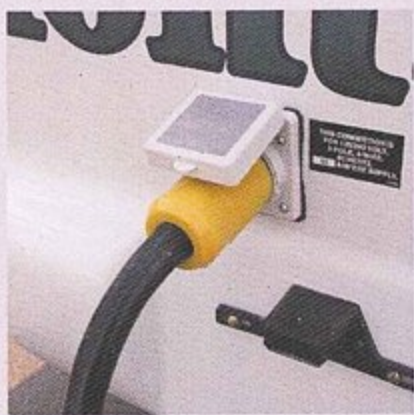

The detachable marine power cord is safe, easy to use and completely sealed.



You'll provide easy, safe entry for everyone with our low first step and folding handrail.

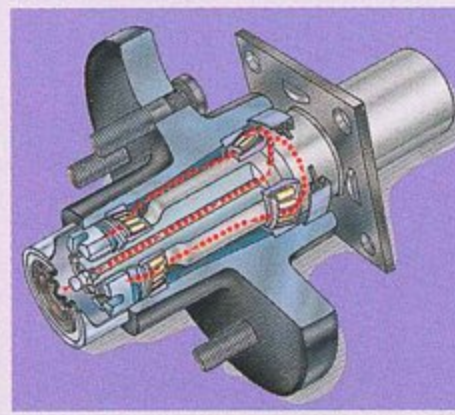

Easy-to-Lube AL-KO™ Axles make it simple to maintain your Montana bearing assembly without removing the wheel.

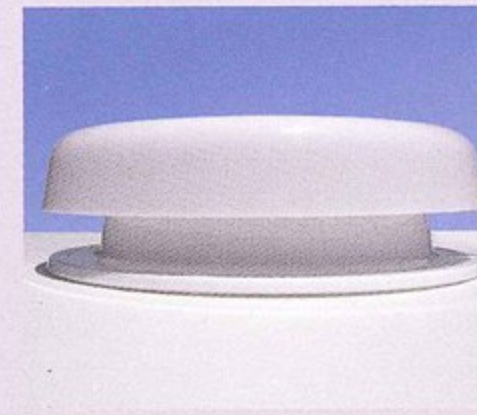

Roof attic vents provide vital escape routes for unwanted moisture that can accumulate with extended use.



Enclosed, protected sewer dump valves are one of many carefully engineered details in the hidden areas of your Montana.

Your Montana Dealer:

Montana Fifth Wheel is a product of the Goshen division of:



17400 Hackberry Drive Goshen, IN 46526
(219) 642-4590 www.keystone-goshen.com



Product information and photography are as accurate as possible at the time of publication. Colors and finishes are photographic representations and may appear differently when viewing actual materials. Some features shown are optional. Features, prices, and specifications are subject to change without notice.

9/01

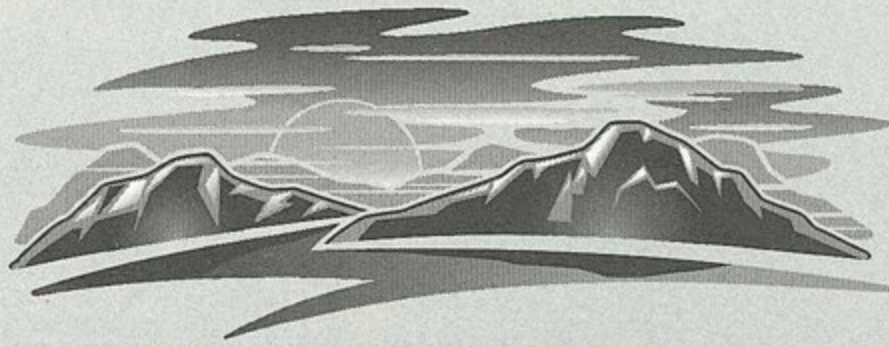

2002
MontanaTM



Towability.

Montana is the finest towing fifth wheel on the market. The reasons are simple and clear — Lightweight aluminum framing lowers the center of gravity which minimizes sway, the aerodynamic cap cuts through the wind rather than pushing it, and Montana has been engineered with great weight distribution. (Notice we even separate the LP bottles to spread the load.)

We receive comments like these daily about the way Montana tows:

"We have a 36' long Montana and it tows like it's not even there. It's a lot lighter than our previous fifth wheel . . . we don't have any problems going up hill anymore. We love our Montana!"

— Bob and Bonnie Durham
Boerne, TX

"The Montana tows better than my previous fifth wheel which was four feet shorter . . . most of the time I don't even know it's behind me. I was also impressed with the gas mileage I got while towing the Montana."

— Donald Schnabel
Huron, SD

"Our Ford 350 powerstroke diesel tows our 35' RL Montana without any trouble. It handles great. Our Montana tows well—we really love it. On a scale of 1-10, we give it a 10."

— John & Twila MacDuffee
Moravia, NY

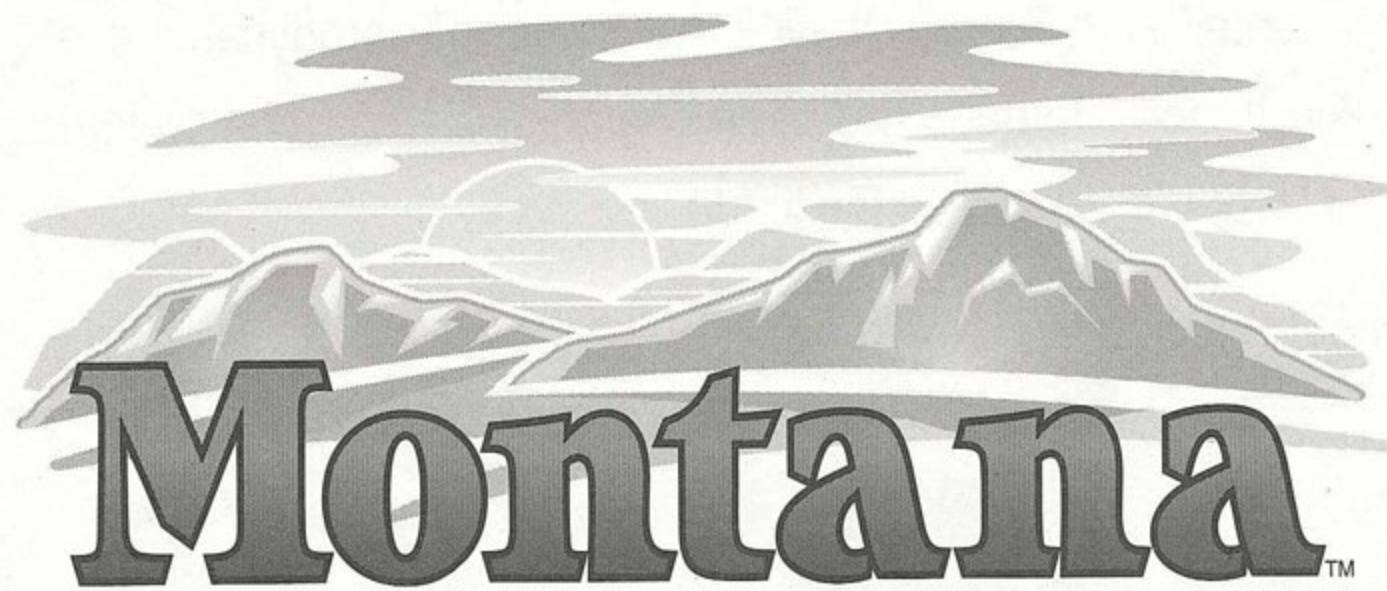
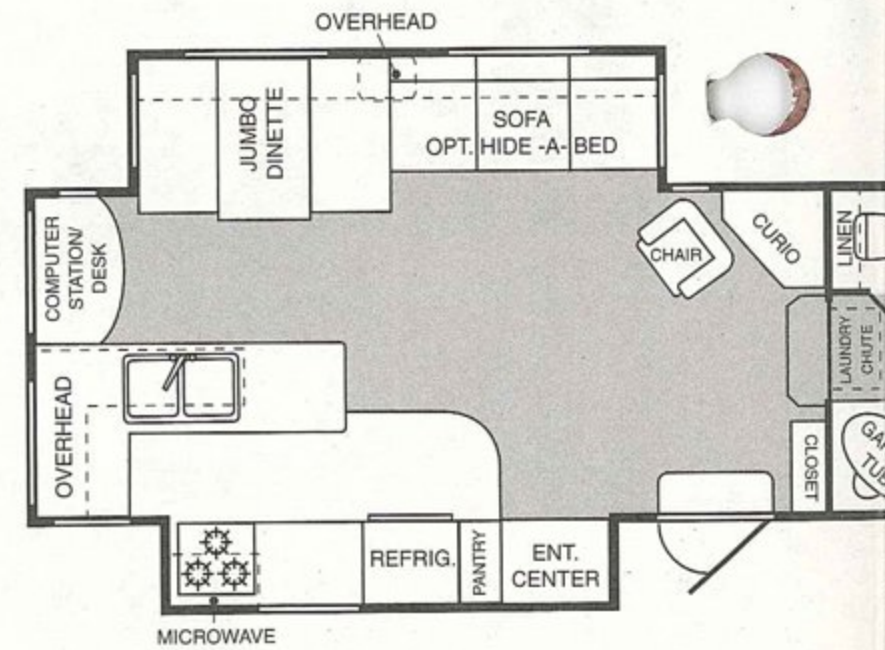
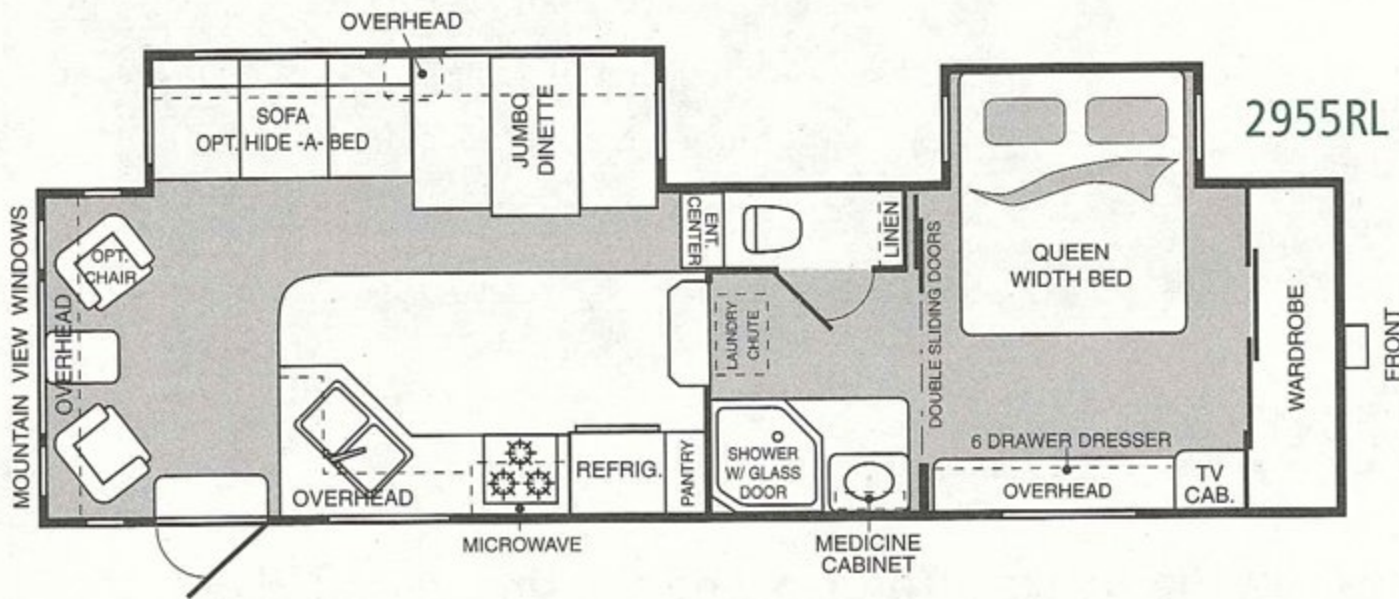
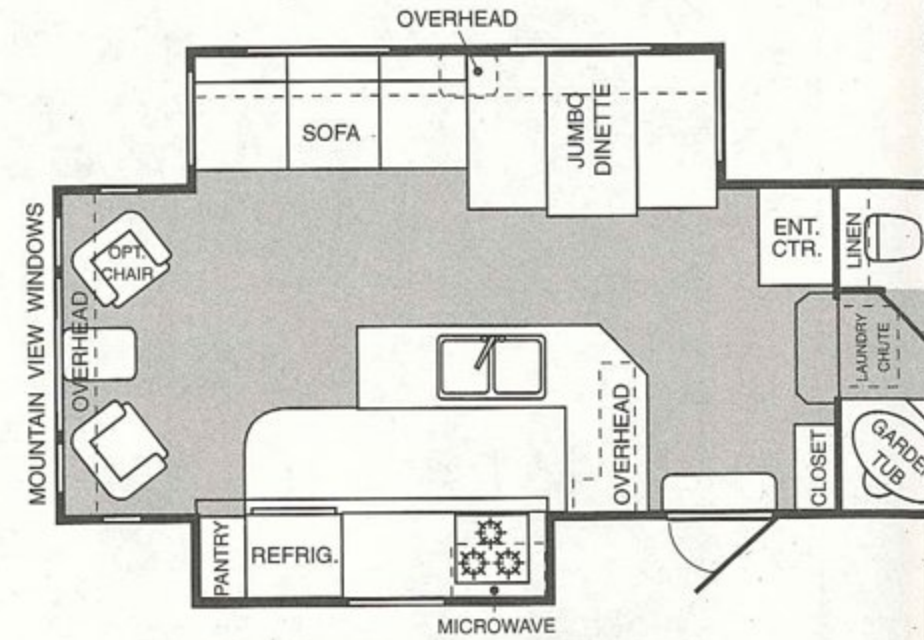
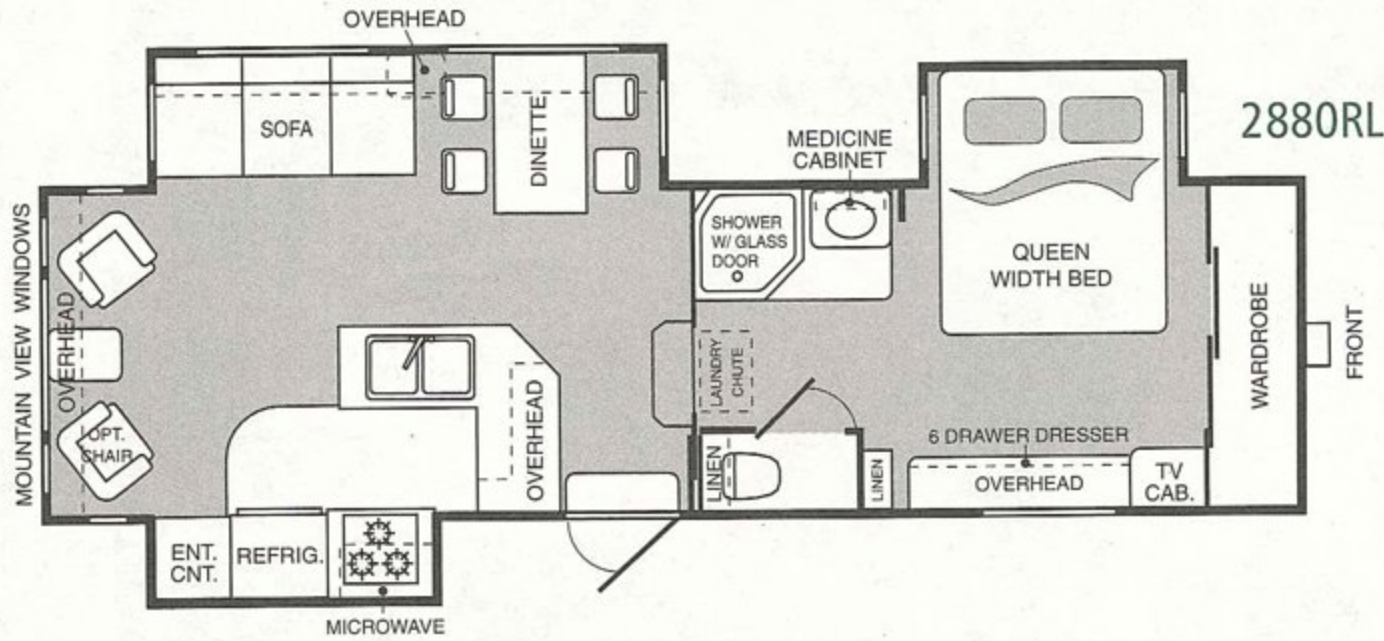
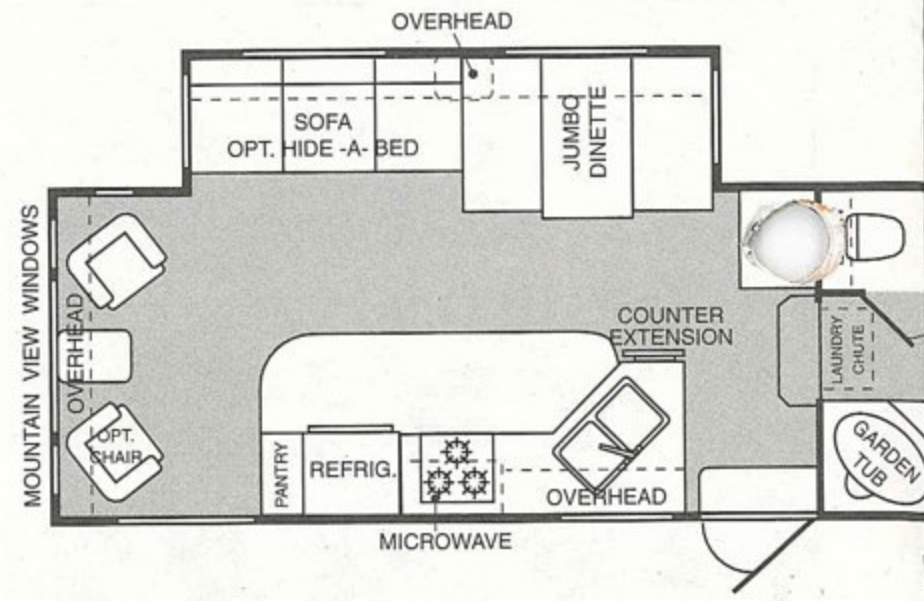
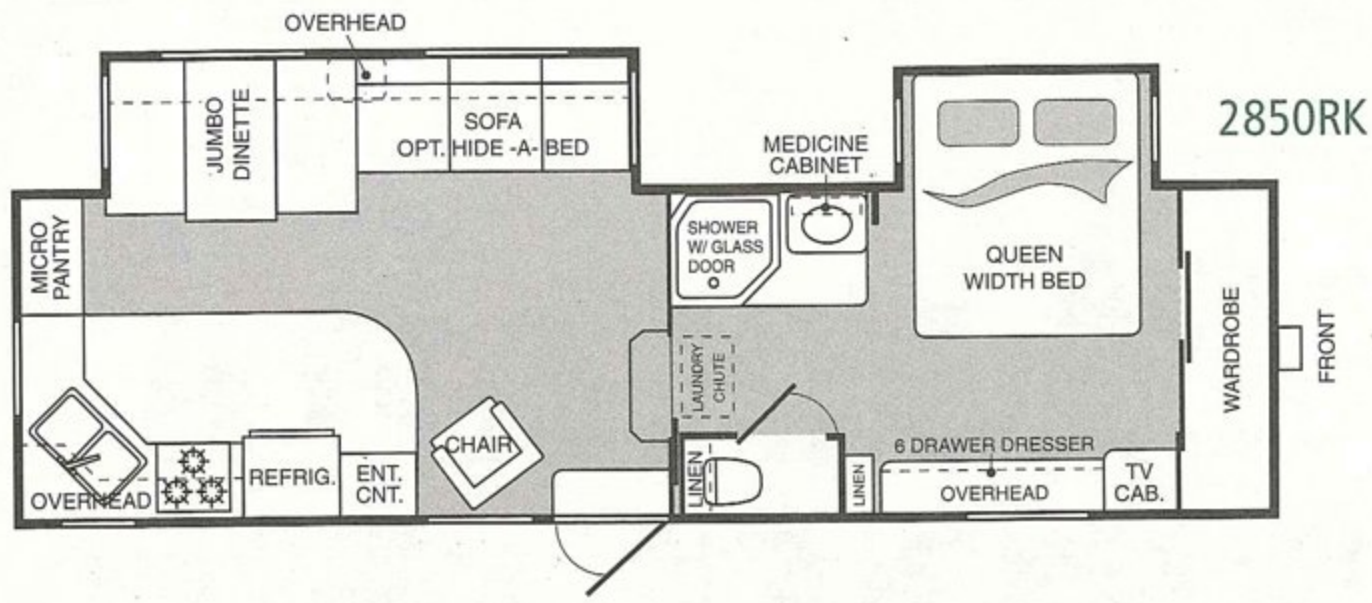

MONTANA IS A PRODUCT OF THE GOSHEN DIVISION OF:



Keystone RV Company

17400 Hackberry Drive, Goshen, Indiana 46526
(219) 642-4590 www.keystone-goshen.com

Montana Fifth Wheel

MODEL NAME	2850RK	2880RL	2955RL
GROSS VEHICLE WEIGHT RATING	11800		
GROSS DRY WEIGHT (UVW) ¹	8326		
CARRYING CAPACITY	3474		
HITCH	1860		
EXTERIOR LENGTH ²	29' 11"		
EXTERIOR HEIGHT (TOP OF A/C)			

¹ Hi-gloss fiberglass option will add approximately 600 lbs.

² Extended hitch pin adds 9"

Product information and photography are as accurate as possible at the time of printing. Some features shown are optional.

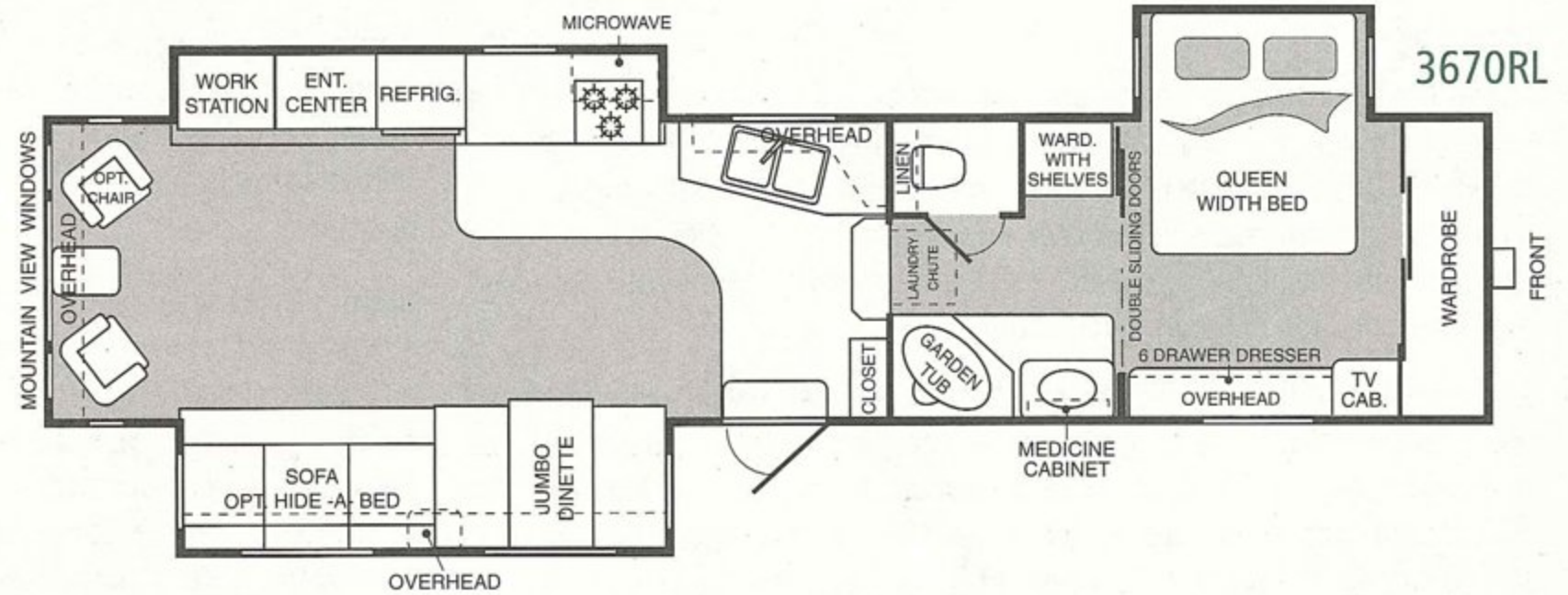
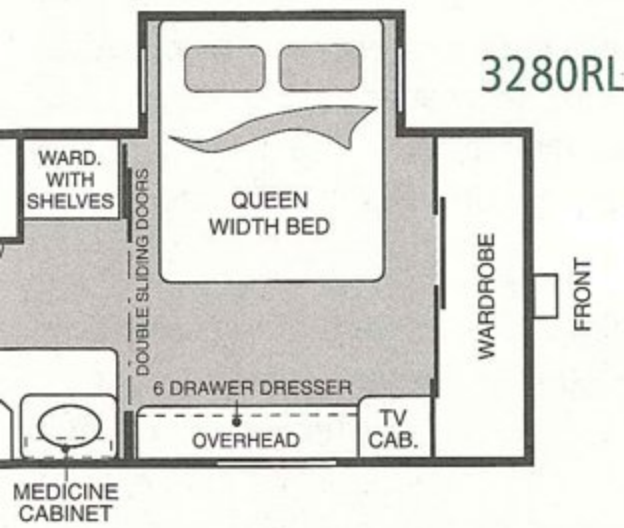
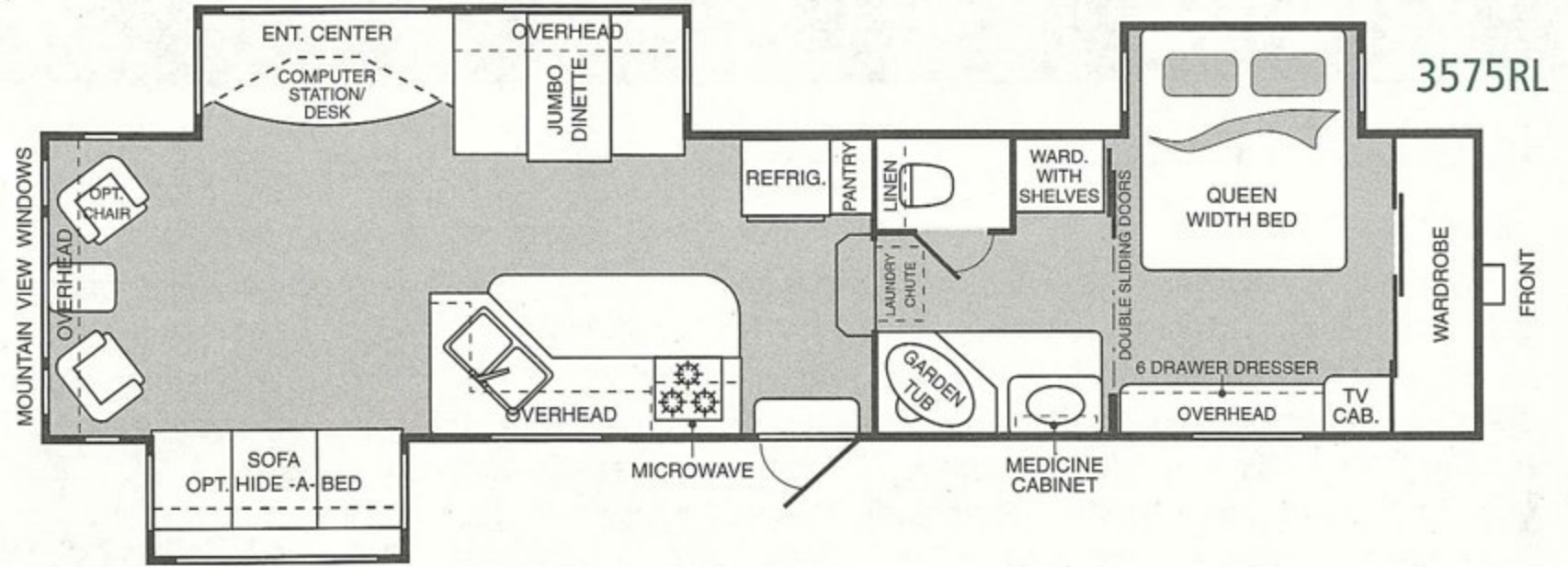
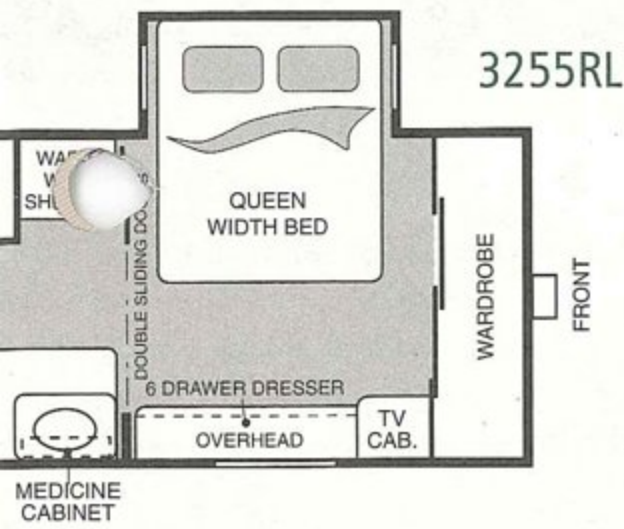

BATH OPTION
(3255 AND LARGER):
Shower w/Glass Enclosure

TOTAL SURROUND™

ALUMINUM STRUCTURE

Many Fifth Wheel brands claim to be aluminum framed, but to cut costs, the manufacturers use wood framed floors and roofs. At Montana, that's not the case. We build 100% aluminum framing all the way around—in the walls, roof and floor.

In addition, for added strength and smoother exterior finish, our walls are 2" thick and are laminated! Check out the difference. You'll be impressed.

Specifications.

30RL	2955RL	3255RL	3280RL	3295RK	3575RL	3670RL
1100	12180	12645	14100	14440	14120	14100
130	9030	9272	9807	10460	9910	10210
970	3150	3373	4293	3980	4210	3890
940	2020	2245	2100	2440	2120	2100
11"	31' 10"	34' 4"	34' 4"	35' 6"	36' 4"	36' 4"
2' 6"	12' 6"	12' 8"	12' 8"	12' 8"	12' 8"	12' 8"

Due to continuous product improvement, modifications may be made without prior notification or obligation. Specifications are calculated as base unit with standard equipment only.

As of publication. Colors and finishes are photographic representations and may appear different. Features, prices and specifications are subject to change without notice. 9/01

Montana Standard Features and Options.

Standard Features.

Exterior

- Welded, totally aluminum-framed walls, roof and floor • 2" Laminated, gel coated Filon™ exterior walls (R-9) • Aerodynamic front and rear fiberglass caps • Outstanding exterior pass-thru storage • Radius baggage doors with inside fasteners • Radius wrap lower walls • Heated, enclosed holding tanks • ABS, fully enclosed underbelly • 16" radial tires (32' and larger) • "Easy-to-Lube" axles* • Deluxe patio awning** • Step well for lower first entry step • Tinted windows* • Extended hitch pin (34' and shorter)** • Vented attic* • Seamless, one-piece floor decking.

Interior

Living Area • 28-oz. carpeting and upholstery with fabric protector • Solid oak cabinet doors with cathedral tops • Entertainment center with TV cabinet • Residential-steel drawer glides • 6' tall slide room with overhead cabinets • Swivel rocker • Jackknife sofa • Mini blinds • 12V rechargeable flashlight near exit* • Computer work station with data port • Flush floor slide room in living room

Kitchen • Oak edge counter top • Cabinet toe kicks* • Lighted range hood with fan • Wide, deep drawers – real wood • Residential-size overhead cabinets • Sink-cover cutting board (1) • Linoleum kitchen floor • Oak knife holder in counter top • Lazy Susan* • White acrylic kitchen sink with hi-arch faucet* • Fluorescent light in kitchen

Bathroom • Garden tub with glass enclosure (3255 and larger) • Neo-angle shower with glass enclosure (2850, 2880, 2955) • Thetford foot pedal toilet* • Adult height vanity • Larger residential-size bath sink • "Shoe closet" storage area • Laundry chute to basement* • Oak edge vanity • Decorative vanity light • Medicine cabinet • Linen shelf with towel hooks

Bedroom • Deluxe innerspring mattress* • Quilted bedspread and 2 pillow shams • 6-drawer dresser • Overhead TV cabinet and outlet • Directional reading lights over bed* • Night stand shelves

Appliances • Large, 8 cubic foot double door refrigerator • RV microwave oven** • AM/FM stereo cassette with four speakers** • 13,500 BTU ducted roof air conditioner with wall thermostat** • High output range with automatic ignitor and 22" oven* • Television** • TV antenna and booster*

Utilities • "Easy-Access" double 30-lb. LP bottles with auto changeover* • No-fuss, "Freezeguard" winterizing kit • Water heater by-pass kit* • 6 gallon gas/electric DSI water heater • Systems monitor panel • 45-amp convertor • 30-amp detachable, marine power cord • Automatic ignition furnace with in-floor ducting • Phone jack / data port • Wall mount telephone* • Cable TV hook-up • Fresh water system – 62 gallons; Grey water – 76 gallons; Black water – 38 gallons

* Customer Convenience Group ** "Moving To Montana" Package

Optional Features.

Exterior

- Outside shower • Safety glass windows • Slide-room awning(s) • Aluminum wheels • Black tank flush • Hi-gloss fiberglass

Interior

- Recliner/glider chair w/footrest (1 or 2) • Day/night shades • Free-standing dinette w/4 chairs • Neo-angle shower w/glass enclosure (3255 and larger) • Decor jackknife sofa • Hide-A-Bed sofa • Plank kitchen floor • Second sink cover • Slide-out oak trim • Table lamp • Sofa table

Equipment

- 15,000 BTU A/C w/Quick Cool • Second 13,500 BTU A/C* • Wire and frame for second A/C* • Satellite prep • Ceiling fan • Fantastic vent fan w/rain sensor • Generator prep • 10 cubic foot double-door refrigerator • Washer/Dryer prep • 50-amp service • 10 gallon gas/electric water heater • Arctic insulation package

Moving To Montana Package:

- Television • Microwave • AM/FM stereo cassette • 13,500 A/C • Awning • Extended hitch pin • Customer Convenience Group

Value Package:

- Bookshelf, AM/FM, CD cassette/stereo • Range cover • Crank-down stabilizer jacks • Electric front jacks • Roof ladder • Fold-away entry/exit handle • Floor safe • Patio scare light: door and roadside • Spare tire and carrier • Skydome • Raised-oak refrigerator front • Shock absorbers

*Requires 50-amp service to run both A/C simultaneously.

Hidden Details.

Montana is a company run by people who know RVing. We build Montana with structural integrity for years of worry-free use. We test and prototype year round to ensure your Montana will be safe, well-engineered, and built for permanence. Many components, such as our cabinetry, are crafted in our own facilities. Only the finest construction materials are used. Then, from the chassis to the roof, we utilize knowhow gathered from many years of experience in our industry. We have the advantage of employing a dedicated workforce from a community that values craftsmanship. You are welcome to visit any of our manufacturing facilities. We're proud of our product and of the people who build Montana for you.

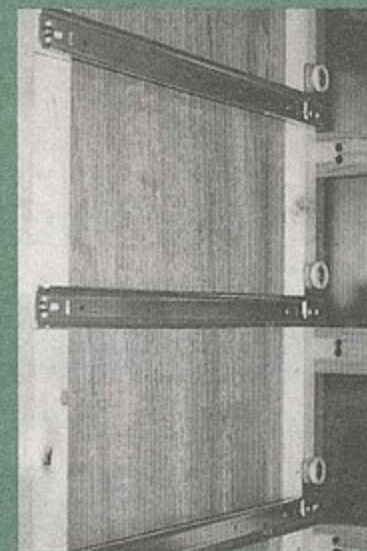

Steel drawer glides with ball bearing rollers are used in all Montana cabinets.

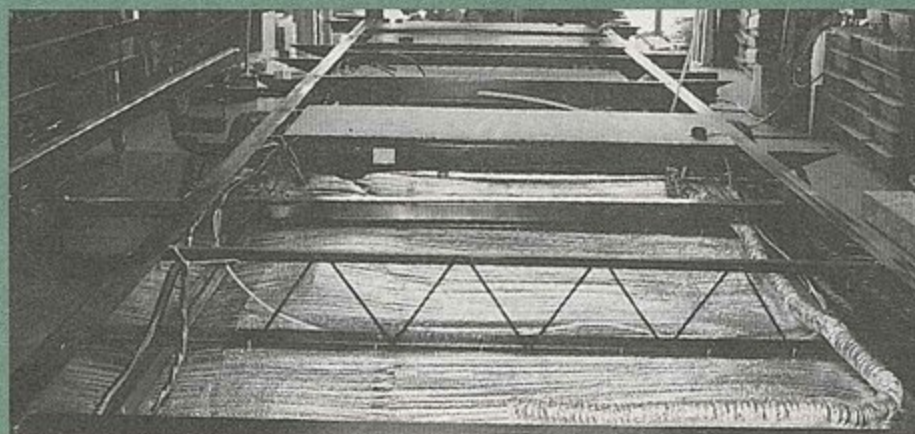

The Arctic Insulation Package includes this Astro Foil Wrap which helps increase the rating to R-21 in the floor.