

# POWERLITE



LUXURY TOY HAULERS



Pacific  
Coachworks

# FS SERIES

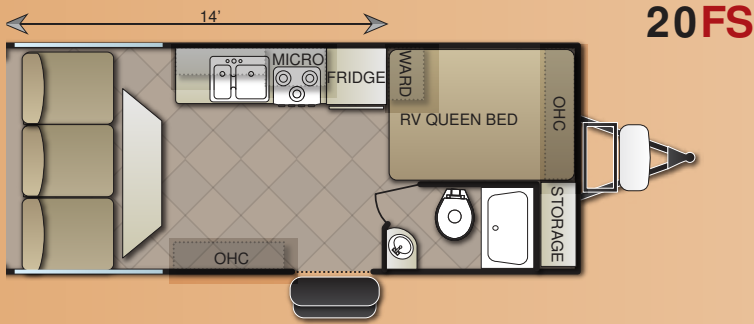

20FS

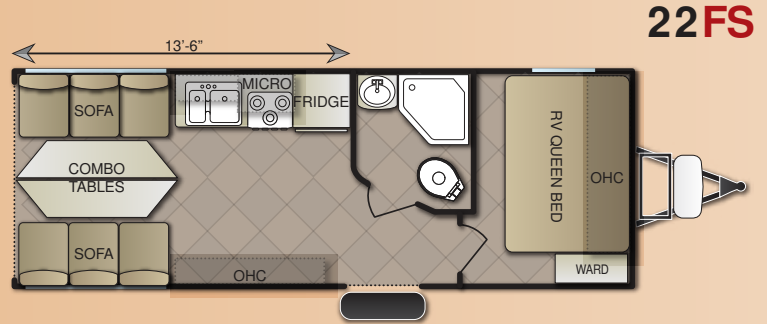

22FS

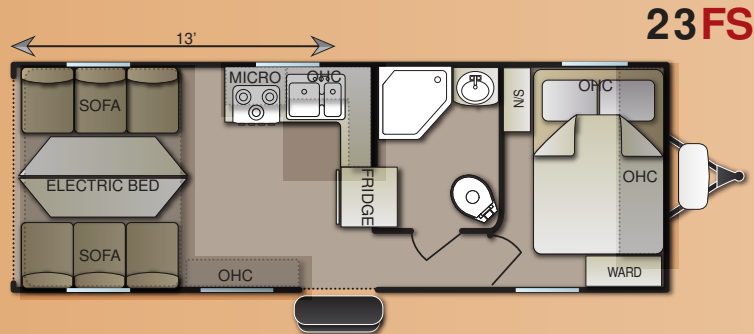

23FS

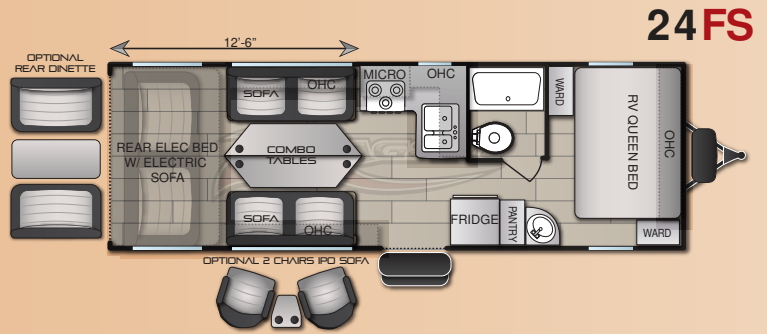

24FS

## INTERIOR FEATURES

- A/C 13.5 BTU Ducted
- Blackout Window Covers / Cargo Area
- Flush Floor Tie Downs
- Laminated Counter Tops w/Edge
- Large Double Door Refrigerator
- Large Oven w/Cooktop

- LED Lighting
- Medicine Cabinet
- Metal Ball Bearing Drawer Guides
- Rear Electric Bed (1)
- Roller Shade Window Coverings
- Screwed Together Cabinet Frames
- Skylight in Bathroom

- Stereo w/Speakers
- Toilet - Porcelain
- Tub Surround
- Upgraded Appliances
- Upgraded Flooring - Next Level
- Upholstered Window Valances

## EXTERIOR FEATURES

- 20 Gallon Fuel Station
- 102" Wide Body Construction
- 5200 LB Axles
- Aluminum Frame Fiberglass Walls
- Awning - Power w/LED
- Blacked Out Wheels

- DSI Water Heater
- Dual LPG Bottles w/Cover - 20 LB
- Fresh Water - 100 Gallon
- Front Diamond Plate
- Keyless Entry Door
- LED Lighting
- Radius Insulated Compartment Door
- Sani Flush - Black Tank

- Solar Ready
- Spare Tire
- Stab Jacks (4)
- Toy Lock - U Channel
- TV Antenna w/Cable Hook-Up
- Upgraded 3M Graphics
- Walk On Roof

## POPULAR OPTIONS

- 160 Solar w/Inverter
- Aluminum Wheels IPO Black
- Bunk Ladder
- Custom Carpet Kit
- Exterior Folding Ladder
- Fiberglass Exterior / Gray

- Flood Light (1) Door Side
- Front Fiberglass Cap
- Generator Onan 4.0 - 24FS Only
- Heated Tanks - Pads
- Microwave Oven
- Patio Cables
- Portable Generator (20FS & 22FS Only)

- Power Tongue Jack
- Pressure Sprayer
- Rear Lift Bed 20FS Only
- Rear Screen Wall
- Sink Cover
- 32" TV - LCD w/Wall Mount
- Winterizing Kit w/Anti-Burst

## SPECIFICATIONS

MODEL	EXT LENGTH	EXT WIDTH	EXT HEIGHT (W A/C)	GVWR	AXLE WEIGHT	HITCH WEIGHT	UVW	PAYLOAD	FRESH WATER	GRAY WATER	BLACK WATER
20FS	25'-10"	102"	11'-6"	9,000	4,585	601	5,186	3,814	100 GAL	40 GAL	40 GAL
22FS	27'-2"	102"	11'-6"	9,000	4,845	633	5,478	3,522	100 GAL	40 GAL	40 GAL
23FS	28'-3"	102"	11'-6"	9,500	5,220	873	6,093	3,407	100 GAL	40 GAL	40 GAL
24FS	31'-3"	102"	11'-6"	9,500	5,560	984	6,519	2,981	100 GAL	40 GAL	40 GAL
25FS	29'-7"	102"	11'-6"	9,500	5,400	1098	6,498	3,002	100 GAL	40 GAL	40 GAL
26FS	29'-7"	102"	11'-6"	9,500	5,485	987	6,472	3,028	100 GAL	40 GAL	40 GAL
27FS	32'-10"	102"	11'-8"	10,200	6,005	888	6,893	3,307	100 GAL	40 GAL	40 GAL
28FS	34'-0"	102"	11'-8"	10,200	5,755	1278	7,035	3,165	100 GAL	40 GAL	40 GAL

Unloaded vehicle weight (UVW) information is intended as a guide only and does not include water, fluids or popular options. Actual weight may vary. Payload capacity does not include the weight of water, fluids, or popular options. Weights and capacities are approximate and are subject to change without notice.

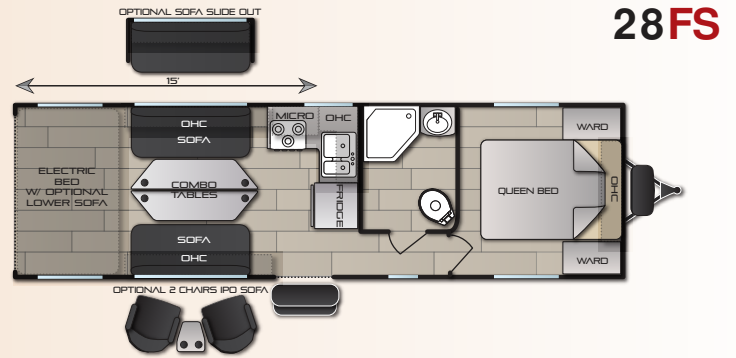
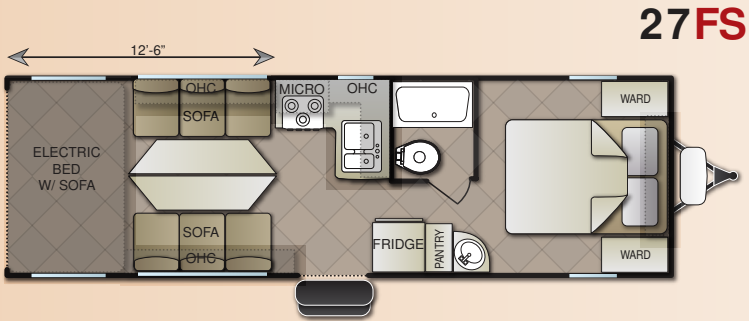
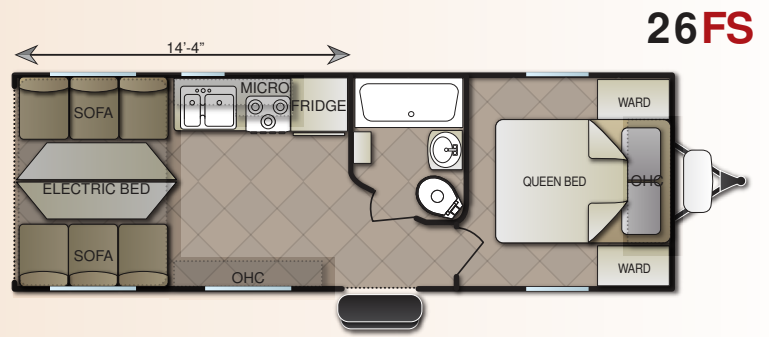
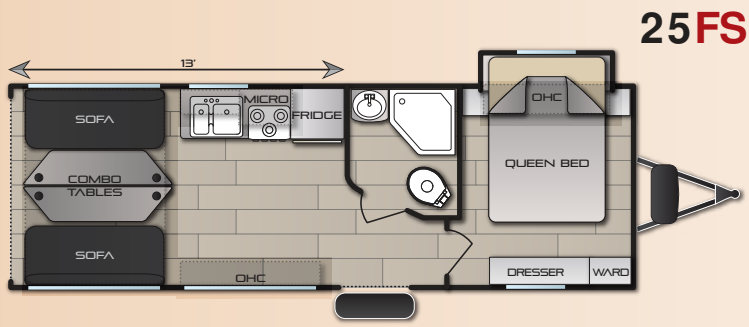

# WIDE BODY & NEXT LEVEL SERIES

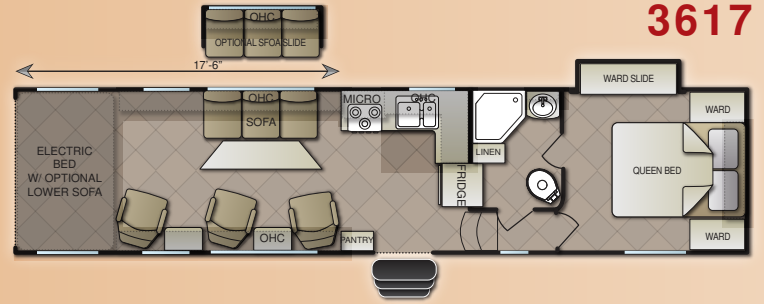
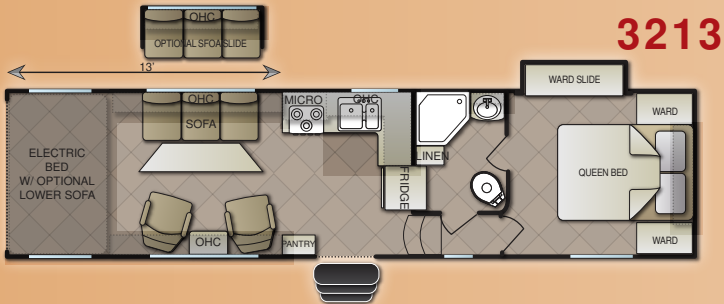
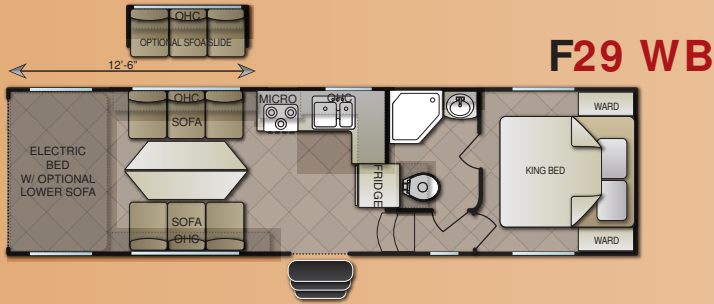

## INTERIOR FEATURES

- A/C 13.5 BTU Ducted (15.0 NL)
- Bunk Ladder
- Custom Carpet Kit - Cargo Area
- Deluxe Ceiling Fan w/LED Lights
- Ducted Furnace - 30,000 BTU (40,000 NL)
- Glass Shower Enclosure
- High Rise Pull Out Galley Faucet
- King Bed (WB Only)
- Laminated Counter Tops w/Edge
- Large Double Door Refrigerator - 6' (8' NL)
- LED Lighting
- Microwave Oven
- Porcelain Toilet
- Range w/Flush Glass Top
- Rear Electric Bed
- Rear "BIG AIR" Lounge
- Roller Shade Window Coverings
- Skylight in Bathroom
- Solid Surface Countertops - Galley Only
- Stereo/Amp/BT/DVD/Subwoofer
- Upgraded Appliances
- Upgraded Flooring - Next Level
- Upgraded Residential Style Furniture
- Wardrobe Slide Out (NL Only)

## EXTERIOR FEATURES

- 8-LUG 7,000 LB Dual Axles (3213)
- 6-LUG 6,000 LB Triple Axles (3617)
- Aluminum Frame Construction
- Awning - Power w/LED Strip
- Blacked Out Wheels
- Beaver Tail Floor w/Cargo (NL)
- Custom 16" Wheels (NL)
- Custom Colored High Gloss Front Cap (NL)
- DSI Water Heater - 6 Gallon
- Dual LPG Bottles w/Cover
- Enclosed Under Belly (NL)
- Equa Flex Suspension (NL)
- Exterior Folding Ladder
- Flood Lights - BLUE (WB)
- Front Diamond Plate
- Generator ONAN 4.0 (5.5 on NL)
- Keyless Entry Door
- One Piece Roof Membrane (NL)
- Power Jacks - Front Only (NL)
- Pressure Washer (NL)
- Radius Entry Door w/Assist Handle
- Radius Insulated Compartment Door (NL)
- Sani Flush - Black Tank
- Solar Ready
- Spare Tire
- TV Antenna w/Cable Hook-Up
- Walk On Roof

## POPULAR OPTIONS

- 15,000 BTU A/C IPO 13,500 (WB)
- 160 w Solar w/Inverter
- A/C Bedroom - 13.5 BTU
- Enclosed Under Belly
- Livingroom Sofa Slide Out
- Patio Cables
- Ramp Patio Fence
- Rear Electric Jacks (NL)
- Rear Screen Wall
- TV - Bedroom 22"
- TV Livingroom - Ceiling Mount 40
- Winterizing Kit

## SPECIFICATIONS

MODEL	EXT LENGTH	EXT WIDTH	EXT HEIGHT (W A/C)	GVWR	AXLE WEIGHT	HITCH WEIGHT	UVW	PAYLOAD	FRESH WATER	GRAY WATER	BLACK WATER	FUEL TANK
<b>F29</b>	34'7"	102"	12'9"	12,800	7,155	2,156	9,311	3,489	120 GAL	50 GAL	50 GAL	40 GAL
<b>F33</b>	38'7"	102"	12'9"	14,800	TBD	TBD	TBD	TBD	120 GAL	50 GAL	50 GAL	40 GAL
<b>3213</b>	35'9"	102"	13'	14,800	6,695	2,840	9,535	5,265	170 GAL	50 GAL	50 GAL	40 GAL
<b>3617</b>	39'9"	102"	13'	17,800	9,830	2,750	12,580	5,220	170 GAL	100 GAL	50 GAL	40 GAL

Unloaded vehicle weight (UVW) information is intended as a guide only and does not include water, fluids or popular options. Actual weight may vary. Payload capacity does not include the weight of water, fluids, or popular options. Weights and capacities are approximate and are subject to change without notice.



25FBXL



29FBXL

# XL SERIES

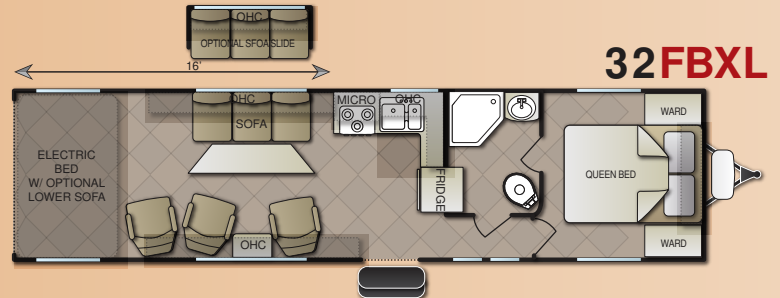
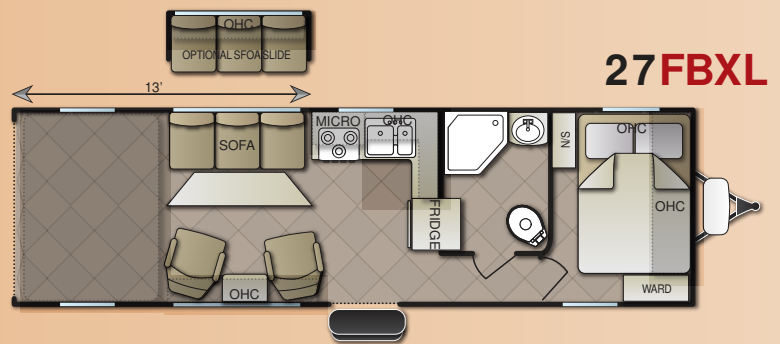
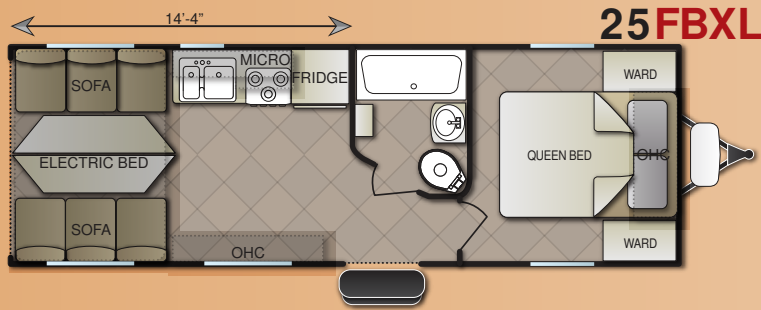

## INTERIOR FEATURES

- A/C 13.5 BTU Ducted
- Bunk Ladder
- Cooktop w/Glass Cover
- Custom Carpet Kit
- Flush Floor Tie Downs
- Large Double Door Refrigerator
- Large Oven
- LED Lighting w/Dimmer
- Metal Ball Bearing Drawer Guides
- Microwave Oven
- Next Level Floor Covering Throughout
- Porcelain Toilet
- Rear Electric Bed
- Rear "BIG AIR" Lounge
- Roller Shade Window Coverings
- Screwed Together Cabinet Frames
- Skylight in Bathroom
- Solid Surface Countertop - Galley Only
- Stereo/Amp/DVD/BT/Subwoofer
- Tub Surround
- Upgraded Appliances

## EXTERIOR FEATURES

- 20 Gallon Fuel Station
- Aluminum Framce Construction
- Awning - Power w/LED
- Blacked Out Wheels
- DSI Water Heater - 6 Gallon
- Dual LPG Bottles w/Cover
- Exterior Folding Ladder
- Flood Lights - BLUE
- Front Diamond Plate
- Generator ONAN 4.0
- Keyless Entry Door
- LED Lighting
- Radius Entry Door w/Assist Handle
- Sani Flush - Black Tank
- Solar Ready
- Spare Tire
- Stab Jacks (4)
- Toy Lock - U Channel
- TV Antenna w/Cable Hook-Up
- Upgraded 3M Graphics
- Walk On Roof

## POPULAR OPTIONS

- 15,000 BTU A/C IPO 13,500
- 40 Gallon Fuel Station IPO 20 Gallon
- 160 Solar w/Inverter
- Aluminum Wheels IPO Black
- Fiberglass Exterior / Gray
- Front Fiberglass Cap
- Glass Bath Enclosure
- Heated Tanks - Pads
- Livingroom Slide Out - N/A 25
- Patio Cables
- Power Stab Jacks / IPO Manual
- Power Tongue Jack
- Pressure Sprayer
- Rear Screen Wall
- 40" TV LCD Wall Mount
- Winterizing Kit

## SPECIFICATIONS

MODEL	EXT LENGTH	EXT WIDTH	EXT HEIGHT (W A/C)	GVWR	AXLE WEIGHT	HITCH WEIGHT	UWV	PAYLOAD	FRESH WATER	GRAY WATER	BLACK WATER
25FBXL	29'-5"	102"	11'-6"	9,900	5,560	1,012	6,572	3,328	100 GAL	40 GAL	40 GAL
27FBXL	33'-8"	102"	11'-8"	10,500	6,475	1,352	7,827	2,673	100 GAL	40 GAL	40 GAL
29FBXL	35'	102"	11'-8"	10,600	6,360	1,384	7,744	2,856	100 GAL	40 GAL	40 GAL
32FBXL	38'	102"	12'-3"	13,900	7,275	1,116	8,391	5,509	100 GAL	40 GAL	40 GAL

Unloaded vehicle weight (UWV) information is intended as a guide only and does not include water, fluids or popular options. Actual weight may vary. Payload capacity does not include the weight of water, fluids, or popular options. Weights and capacities are approximate and are subject to change without notice.

# TOP SHELF SERIES

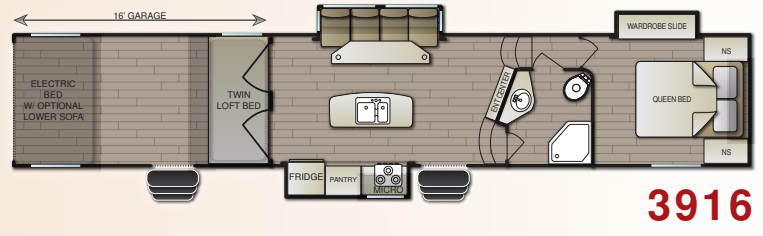
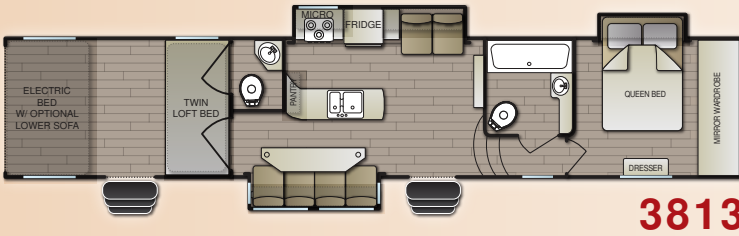
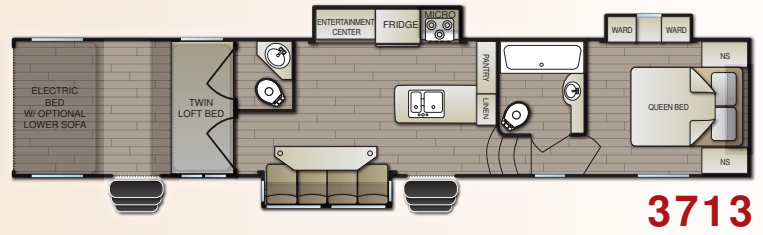
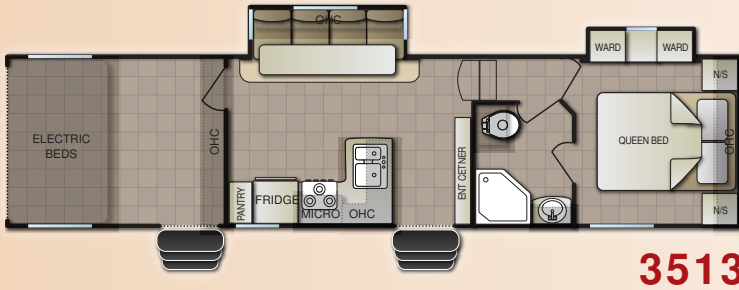

## INTERIOR FEATURES

- A/C 15.0 BTU Ducted
- 1 Piece Fiberglass Tub Surround
- Beaver Tail Floor w/Storage Bin
- Bunk Ladder
- Custom Carpet Kit - Cargo Area
- Dimmable LED Lighting
- Double Carpet Padding - Bedroom
- Ducted Furnace - 40,000 BTU
- Glass Flush Mount Cooktop
- Glass Shower Enclosure
- High Rise Pullout Galley Faucet
- Large Double Door Refrigerator
- Large Pots & Pans Drawer in Galley
- LINC PAD Universal Technology
- Max Air Vent in Living Area
- Metal Ball Bearing Drawer Guides
- Microwave Oven 30" RESIDENTIAL
- Next Level Floor Covering
- Porcelain Toilet
- Rear Electric Bed w/Roll Over Dinette
- Roller Shade Window Coverings
- Skylight in Bathroom
- Solid Surface Tops - Galley & Lavvy
- Stainless Appearance Appliances
- Stereo/Amp/BT/DVD/SUB/Sound Bar
- TV LCD - 40"
- Upgraded Residential Style Furniture
- Washer/Dryer Prep

## EXTERIOR FEATURES

- 20/40 Gal Fuel Tank w/Pump Station
- 7000 LB Triple Axles - 8 LUG
- 8' Ramp Door w/Gray Fiberglass
- Aluminum Frame Fiberglass Exterior Walls
- Awning - Power w/LED Strip
- Custom 16" Aluminum Wheels
- Custom Colored High Gloss Front Cap
- DSI Water Heater - 10 Gallon
- Enclosed Under Belly
- Equa Flex Suspension
- Exterior Ladder
- Exterior Utility Command Center
- Front Diamond Plate
- Generator ONAN 5.5
- Gray Slide Out End Walls & Ramp Door
- Ground Effects Light Package
- Keyless Entry Door
- Lippert Level Up System
- Pressure Washer
- Roto Flex Front Hitch
- Sani Flush - Black Tank
- Sink Cover
- Slam Latch - Radius Compartment Doors
- Solar Ready
- Spare Tire
- TV Antenna w/Cable Hook-Up
- Ultra High Gloss Medallion Exterior
- Walk On Roof

## POPULAR OPTIONS

- 160 Solar w/Inverter
- 2nd Lift Bed & Dinette (3916 Only)
- A/C Bedroom - 13.5 BTU
- A/C Cargo Area
- Diamond Plate Flooring - Cargo Area
- Electric Rear Awning Over Ramp Door
- Optional Fireplace in Living Area
- Patio Cables
- Ramp Patio Fence
- Rear Screen Wall
- Winterizing Kit

## SPECIFICATIONS

MODEL	EXT LENGTH	EXT WIDTH	EXT HEIGHT (W A/C)	GVWR	AXLE WEIGHT	HITCH WEIGHT	UVW	PAYLOAD	FRESH WATER	GRAY WATER	BLACK WATER	FUEL TANK
3513	41'11"	102"	13'	16,800	9,830	2,750	12,580	4,220	170 GAL	50 GAL	90 GAL	40 GAL
3713	44'3"	102"	13'2"	20,800	10,755	3,906	14,661	6,139	170 GAL	50 GAL	90 GAL	40 GAL
3813	44'9"	102"	13'2"	20,800	11,410	3,510	14,920	5,880	170 GAL	100 GAL	90 GAL	40 GAL
3916	44'9"	102"	13'2"	20,800	10,820	3,160	13,980	6,820	170 GAL	100 GAL	90 GAL	40 GAL

Unloaded vehicle weight (UVW) information is intended as a guide only and does not include water, fluids or popular options. Actual weight may vary. Payload capacity does not include the weight of water, fluids, or popular options. Weights and capacities are approximate and are subject to change without notice.

**Pacific Coachworks** is committed to providing the highest quality travel trailers, fifth wheel units, and toy haulers at an unsurpassed value. We are dedicated to establishing lasting partnerships with trusted RV dealers, vendors, and suppliers, all of which are equally committed to conducting business with your best interests in mind. The Pacific Coachworks team is focused on exceeding customer expectations by providing the highest level of customer support and service.

All information included in this brochure is the latest at the time of publication. Pacific Coachworks reserves the right to make changes and to discontinue at any time, without notice, prices, colors, materials, equipment, accessories, specifications, models, and packages, without incurring any obligations to make the same or similar changes to trailers. All vehicles built by Pacific Coachworks, Inc. include a one year factory warranty.



photo courtesy of Wolfpack UTV race team

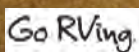

Your local dealer:

