

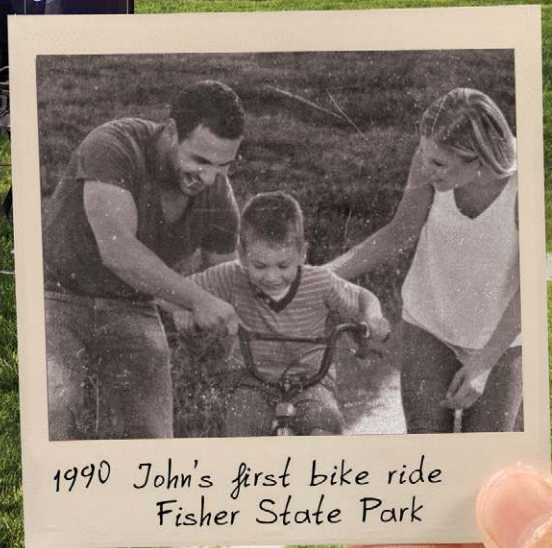

2019 WHITE HAWK



1990 John's first bike ride
Fisher State Park

2
YEAR
LIMITED
WARRANTY

WHITE HAWK



29FLS MAIN INTERIOR



29FLS BEDROOM



23MRB MURPHEY BED UP



23MRB MURPHEY BED DOWN



32BHS MAIN INTERIOR



32BHS BEDROOM CLOSET



32BHS BUNK/BATHROOM

WHITE HAWK FLOORPLANS

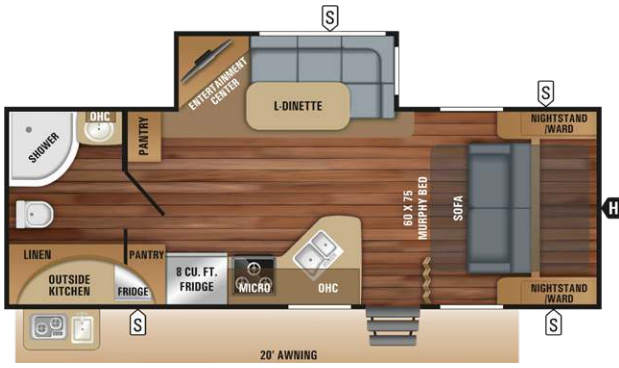

23MRB OPTION A

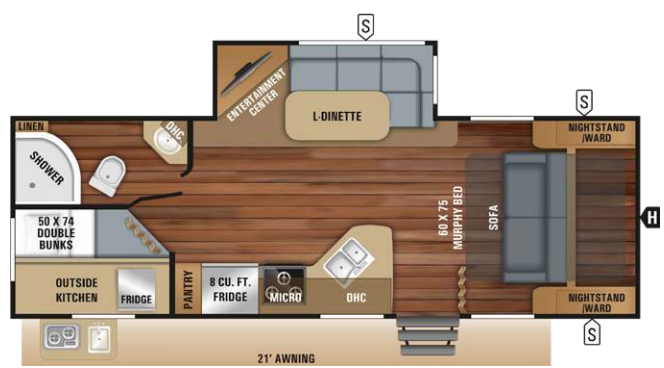

24MBH OPTION A

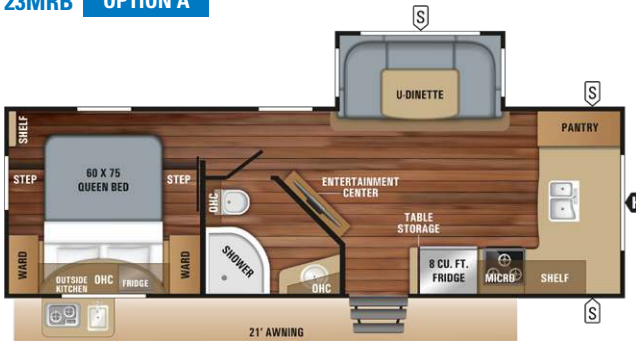

25FK OPTIONS: A, B

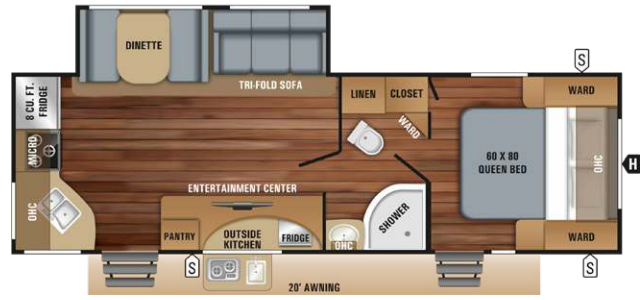

26RK OPTIONS: A, B

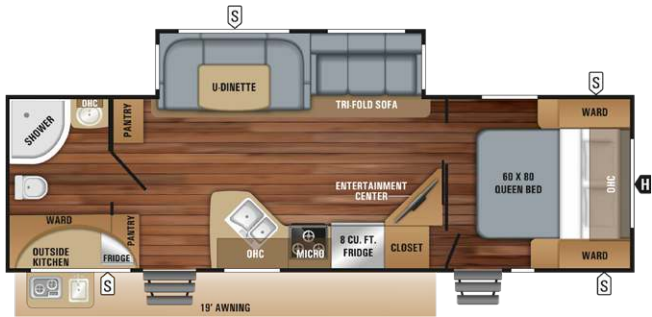

27RB OPTIONS: A, B

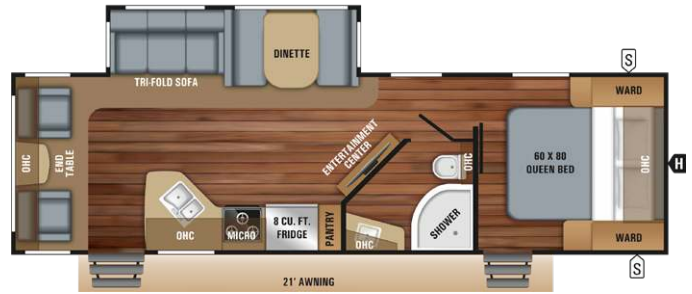

28RL OPTIONS: A, B

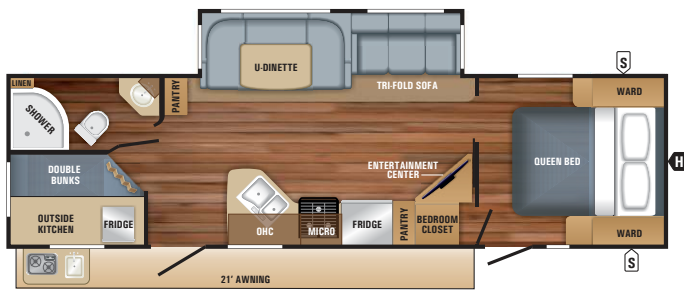

29BH OPTIONS: A, B

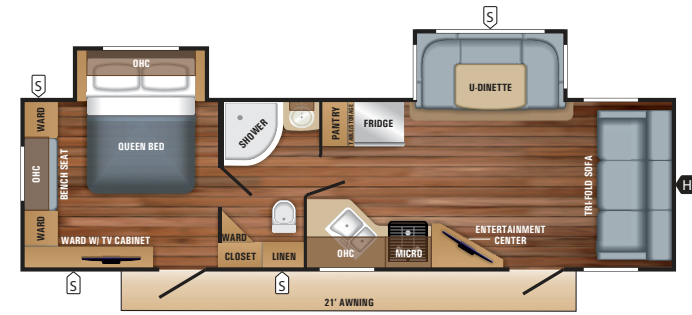

29FLS OPTIONS: A, B

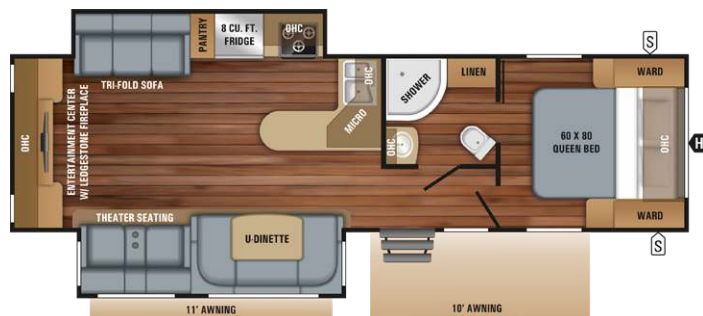

29RE OPTION A

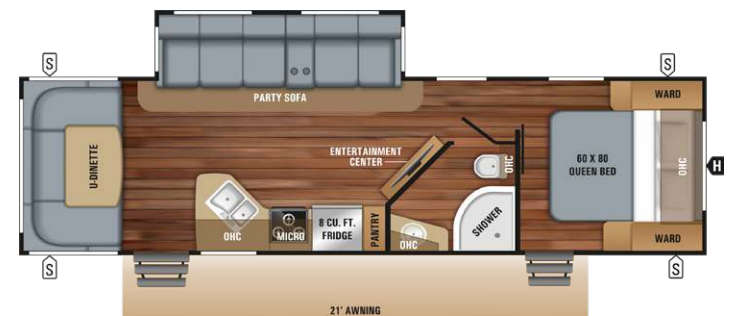

30RD

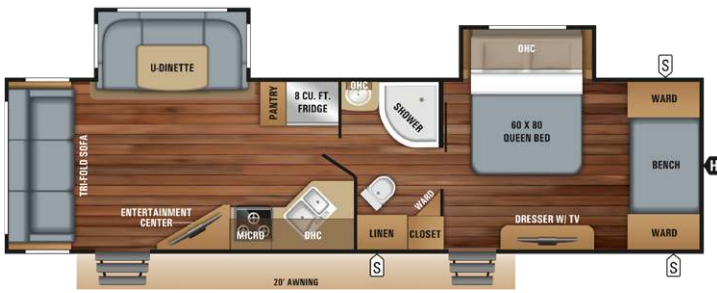

30RLS OPTIONS: A, B

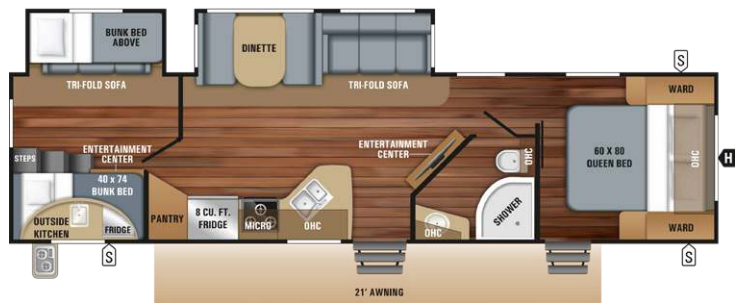

31BH OPTIONS: A, B

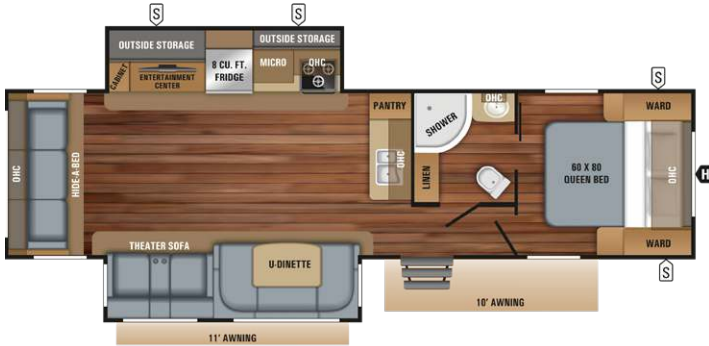

31RL OPTION A

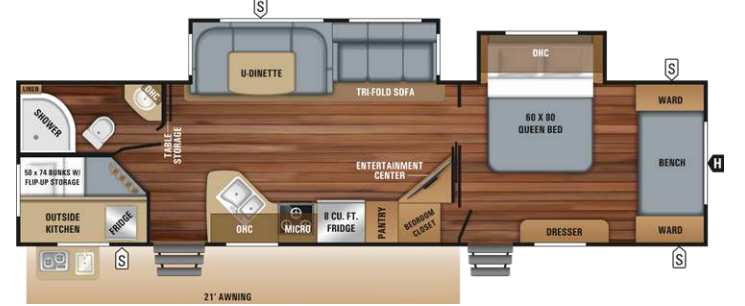

32BHS OPTIONS: A, B

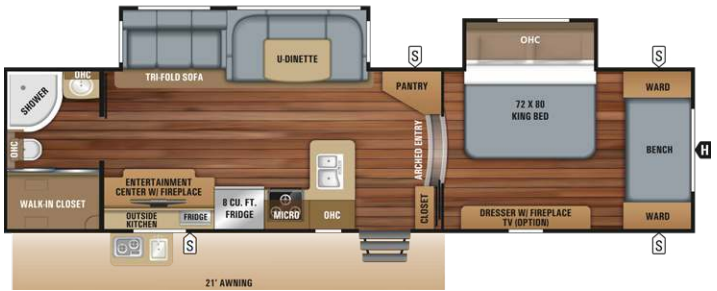

32KBS OPTIONS: A, B

LEGEND

- STORAGE
- TRAILER HITCH
- MICRO MICROWAVE
- OHC OVERHEAD CABINETS
- FRIDGE REFRIGERATOR
- WARD WARDROBE

OPTIONS

OPTION A

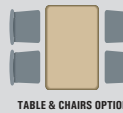
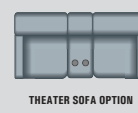

TABLE & CHAIRS OPTION

OPTION B



THEATER SOFA OPTION

SPECS

FLOORPLAN	EXTERIOR TRAVEL LENGTH	EXTERIOR WIDTH	EXTERIOR HEIGHT W/AC	INTERIOR HEIGHT	UNLOADED VEHICLE WEIGHT (LBS.)	DRY HITCH WEIGHT (LBS.)	GROSS VEHICLE WEIGHT RATING (LBS.)	CARGO CARRYING CAPACITY (LBS.)	FRESH WATER CAPACITY (GAL.) (INCLUDES WATER HEATER)	GREY WASTE WATER CAPACITY (GAL.)	BLACK WASTE WATER CAPACITY (GAL.)	SLEEP CAPACITY
23MRB	28' 2"	8' 0"	10' 11"	6' 9"	5,385	475	7,250	1,865	48	30.5	30.5	3 - 4
24MBH	29' 2"	8' 0"	10' 11"	6' 9"	5,625	565	7,350	1,725	48	30.5	30.5	7 - 8
25FK	TBD	8' 0"	TBD	6' 9"	TBD	TBD	TBD	TBD	48	TBD	30.5	3 - 4
26RK	31' 2"	8' 0"	10' 11"	6' 9"	6,165	780	7,750	1,585	48	61**	30.5	5 - 6
27RB	32' 8"	8' 0"	10' 11"	6' 9"	6,510	645	8,200	1,690	48	61**	30.5	5 - 6
28RL	33' 4"	8' 0"	11' 3"	6' 9"	6,475	675	8,150	1,675	48	61**	30.5	5 - 6
29BH	34' 7"	8' 0"	11' 3"	6' 9"	6,945	750	8,500	1,555	48	61**	30.5	9 - 10
29FLS	34' 6"	8' 0"	11' 3"	6' 9"	6,800	770	8,350	1,550	48	61**	30.5	5 - 6
29RE	35' 0"	8' 0"	11' 4"	6' 9"	7,315	795	8,950	1,635	48	30.5	30.5	5 - 6
30RD	35' 3"	8' 0"	11' 3"	6' 9"	6,620	790	8,500	1,880	48	61**	30.5	4 - 5
30RLS	36' 2"	8' 0"	11' 4"	6' 9"	7,290	850	8,750	1,460	48	30.5	30.5	5 - 6
31BH	37' 6"	8' 0"	11' 4"	6' 9"	7,715	790	9,500	1,785	48	61**	30.5	10 - 14
31RL	36' 11"	8' 0"	11' 4"	6' 9"	7,650	885	9,250	1,600	48	30.5	30.5	5 - 6
32BHS	37' 10"	8' 0"	11' 4"	6' 9"	7,575	810	8,995	1,420	48	61**	30.5	9 - 10
32KBS	TBD	8' 0"	TBD	6' 9"	TBD	TBD	TBD	TBD	48	TBD	30.5	5 - 6

*Split tanks

Unloaded Vehicle Weight (UVW): Sometimes referred to as "Dry Weight," UVW means the typical weight of this trailer as built at the factory. The UVW, as used in product literature and other promotional materials, does not include cargo, fresh water, propane, options or dealer-installed accessories.

Gross Vehicle Weight Rating (GVWR): GVWR means the maximum permissible weight of the trailer, including the UVW plus personal items, all cargo, fluids, options and dealer-installed accessories. The GVWR is equal to or greater than the sum of the UVW and the CCC.

Cargo Carrying Capacity (CCC): CCC means the maximum weight of personal items, food, fresh water, propane, tools, other cargo and dealer-installed accessories that can be carried by the trailer. CCC is equal to or less than GVWR minus UVW. The addition of options will decrease the CCC.

Hitch Weight (HW): The hitch weight, as used in product literature and other promotional materials, does not include cargo, fresh water, propane gas, options or dealer-installed accessories. The addition of these types of items will either add to or subtract from the stated hitch weight.

It is important for your safety and enjoyment that your tow vehicle be adequately sized and equipped to tow and handle the GVWR of the RV you select. Review weights and rating of your tow vehicle and consult a competent advisor for questions or advice. Whether you are new to RVing or a veteran, get a feel for the performance of your tow vehicle before heading out on the roadways. When you tow an RV, you must drive differently than when you drive a single vehicle. Practice hooking up, driving, backing up and braking in a safe environment or seek out professional instruction. Jayco affixes a weight label to each RV which lists weight information for that vehicle. See specifications chart above.

STANDARDS AND OPTIONS

STANDARD EXTERIOR EQUIPMENT

Aerodynamic, rounded front profile with front diamond plate
 Stronghold VBL™ vacuum-bonded, laminated side, rear and front walls (including slideout room walls)
 Magnum Truss™ Roof System with seamless DiFlex II material
 5/8 inch tongue and groove plywood decked flooring
 Norco® NextGen frame with integrated A-frame
 G-20 dark tinted safety-glass windows
 30 inch friction hinged main entry doors (most models)
 Swing out grab handle
 Exterior TV bracket with 110V and cable outlets
 Outdoor Camp Kitchen with embossed metal countertops (select models)
 Slam latches on front pass-through storage doors (select models)
 Marine-grade exterior speakers (2)
 American-made Dexter® axles with EZ Lube®
 Galvanized steel, impact-resistance wheel wells
 Slide out rooms with double seals, barrier sponges and U-channel drip spouts
 30 amp service
 Stabilizer jacks with sand pads (4)
 Furrion® mounted camera bracket for pre-wired rear back-up prep
 Keyed Alike™ lock system
 Detachable power cord
 Exterior LED lighting
 A-Frame mounted solar prep

STANDARD INTERIOR EQUIPMENT

Solid hardwood, jointed cabinets with screwed and glued lumbercore cabinet stiles
 Overhead cabinetry with smoked glass inserts
 Deep, split bowl, stainless steel sink with high rise, pullout faucet and dry rack/sink cover combo
 3 burner 9,000-BTU range
 Decorative backsplash
 Ball-bearing drawer glides with 75 lb. capacity
 Arched interior ceiling
 LED lighting throughout
 Directional and closeable central air conditioner vents
 AM/FM/CD/DVD/Bluetooth® stereo with speakers
 Plywood dinette, bunk and bed bases
 Woodgrain accent paneling on select interior walls
 60 inch x 80 inch queen beds (60 inch x 75 inch in 23MRB, 24BHM, and 25FK)
 Jayco exclusive Simmons® mattress with bedspread (N/A 23MRB and 24BHM)
 Murphy bed design allowing pass-through exterior storage access (select models)
 Full height hanging wardrobes with adjustable shelves
 Solid wood door enclosures for master bedroom (N/A Murphy bed models)
 Full bedroom closet (27RB, 29BH, 32BHS)
 Fixed bunks with 110V outlet and corner shelf
 Jayco exclusive teddy bear "Soft-Touch" bunk mats (bunk models only)
 Bathroom medicine cabinets
 14 inch x 14 inch powered roof vents in bathroom and main bedroom
 Residential vinyl plank flooring with cold crack resistance
 High output auto ignition furnace with wall thermostat
 Stainless steel appliances with upgraded cooktop burner
 2'x4' folding picnic table (N/A 29FLS, 30RLS, 32KBS)

CUSTOMER VALUE PACKAGE (MANDATORY)

American-made nitro-filled Goodyear® radial tires
 Self-adjusting electric brakes
 Solar prep (roof mounted)
 8 cu. ft. refrigerator with stainless front panels
 Porcelain foot flush toilet
 34 inch radius showers with solid enclosure
 40 inch LED TV (N/A on 32KBS)
 50 inch LED TV (32KBS Only)
 Black tank flush
 Roof ladder
 13,500 BTU air conditioner
 Spare tire with cover
 Stainless steel microwave
 6 gallon gas/electric auto ignition water heater
 ABS propane bottle cover
 30 lb. propane bottles (2)
 Bath skylight
 Outside shower
 Oven
 Aluminum rims
 Power awning with LED light
 Power tongue jack
 Detachable power cord

50TH ANNIVERSARY PACKAGE (MANDATORY)

Enclosed underbelly with glacier package
 Kitchen skylight with shade
 Front molded fiberglass cap with automotive-style windshield and blue LED accent lighting
 Frameless windows
 Aluminum tread entry steps
 Solid-surface kitchen countertops

OPTIONS

Customer Value Package (MANDATORY)
 Customer Value Package with 15,000 BTU air conditioner
 Freestanding table with 4 chairs in place of booth dinette (select models)
 Theater seating with heat, massage, and LED lighting (select models)
 2nd 13,500 BTU A/C (requires 50 amp service)
 30 amp electric fireplace
 50 amp service with 2nd A/C prep (required with 2nd A/C)
 Power stabilizer jacks
 Outside bumper-mount grill
 Fan-Tastic Fan power roof vent (location varies by model)
 Norco stabilizing system with 4 power jacks, 2 lock arms, and power tongue jack with stabjack controls

INTERIOR DÉCOR

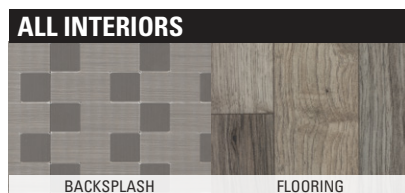
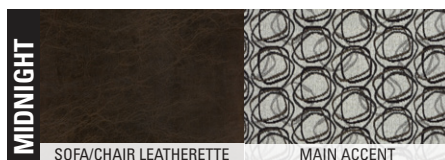
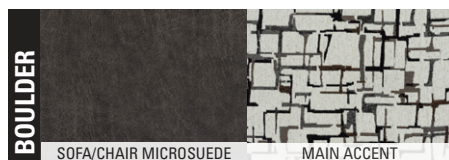

WHITE HAWK COMPETITIVE ADVANTAGES



8 CU. FT. REFRIDGERATOR



40" LED TV (50" IN 32KBS)



34 INCH RADIUS SHOWER WITH SOLID ENCLOSURE



FRONT FIBERGLASS CAP WITH AUTOMOTIVE-STYLE WINDSHIELD AND BLUE LED LIGHTING



FRAMELESS WINDOWS



ALUMINUM TREAD STEPS



EMBOSSED METAL OUTSIDE KITCHEN COUNTERTOPS



SOLID-SURFACE COUNTERTOPS WITH UNDERMOUNT SINK



KITCHEN SKYLIGHT WITH SHADE



AMERICAN-MADE DEXTER AXLES WITH SELF-ADJUSTING BRAKES AND GALVANIZED WHEEL WELLS

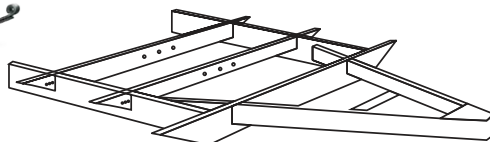

AMERICAN-MADE NORCO NEXT-GEN FRAME WITH INTEGRATED A-FRAME



ENCLOSED UNDERBELLY WITH GLACIER PACKAGE

Is your tow vehicle WHITE HAWK ready?



Scan to learn more

2
YEAR
WARRANTY

TRAVEL WITH CONFIDENCE

At Jayco, we build our RVs to handle every adventure, then back them with our industry-leading 2-year limited warranty. We, with support from our select partners, have you covered for **2 camping seasons**. That's **730 days**. You won't find a better warranty in the business, because the only strings we attach are those that deliver the ultimate in reliability. That's the Jayco difference. So go explore. For a copy of our 2-year limited warranty with complete terms and conditions, please contact your local Jayco dealer.



JAYCO'S ROOF vs. OTHER ROOFS



4,500 POUNDS ON A JAYCO ROOF VS. OTHER ROOFS

THE MAGNUM TRUSS™ ROOF SYSTEM 50 percent stronger

GOODYEAR

Featuring Durawall® Technology—ENGINEERED
to help you tow with confidence



MADE IN USA



Jayco, Inc. | P.O. Box 460 | Middlebury, IN 46540  

See dealer for further information and prices. All information in this brochure and on www.jayco.com is the latest available at the time of publication approval. Jayco reserves the right to make changes and to discontinue models without notice or obligation. Photography may show optional equipment or props used for decoration purposes only. RVs built for sale in Canada may differ to conform to Canadian codes. JAYCO and the JAYCO BIRD IN FLIGHT are registered trademarks of Jayco, Inc. Printed in USA 75K 7/2018 ©2018 Jayco, Inc. 274876

Follow Jayco
#Jayco50



Meet your Jayco Dealer _____

We work hard—so you can play hard. From finding the perfect Jayco for your family to providing flexible financing options and full-service support, we're here to help.