

SPYDER

TOY HAULER



Legendary quality.
Redefining recreation.

WINNEBAGO

WINNEBAGO

SPYDER

TOY HAULER

LEGENDARY QUALITY.
REDEFINING RECREATION.



- Visit WinnebagoInd.com for more info
- Join a boundless community of adventurers at Witclub.com



Photos are of Spyder 28KS with Noble interior decor

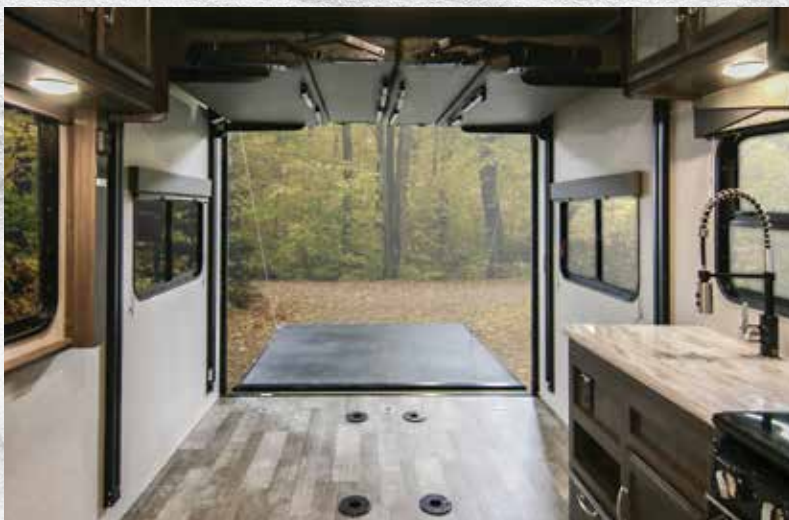

The massive Toy Hauler garage features dependable frame-bolted D-Rings that keep your favorite gear protected and latched down, no matter what terrain comes your way.



All floorplans include a private bedroom, king bed, and kitchen area with top-of-the-line appliances.

SPYDER // 23FS / Sleeps 4

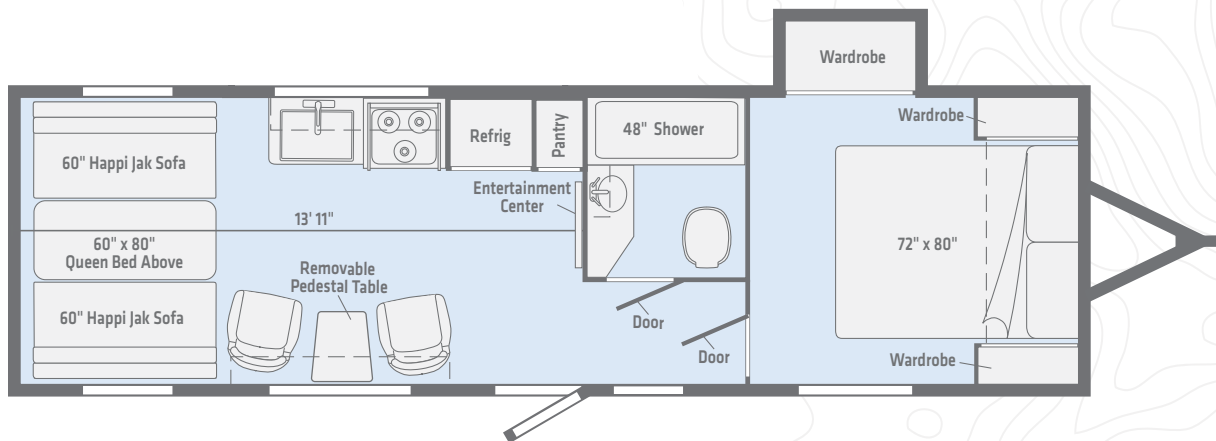

SPYDER // 28KS / Sleeps 5

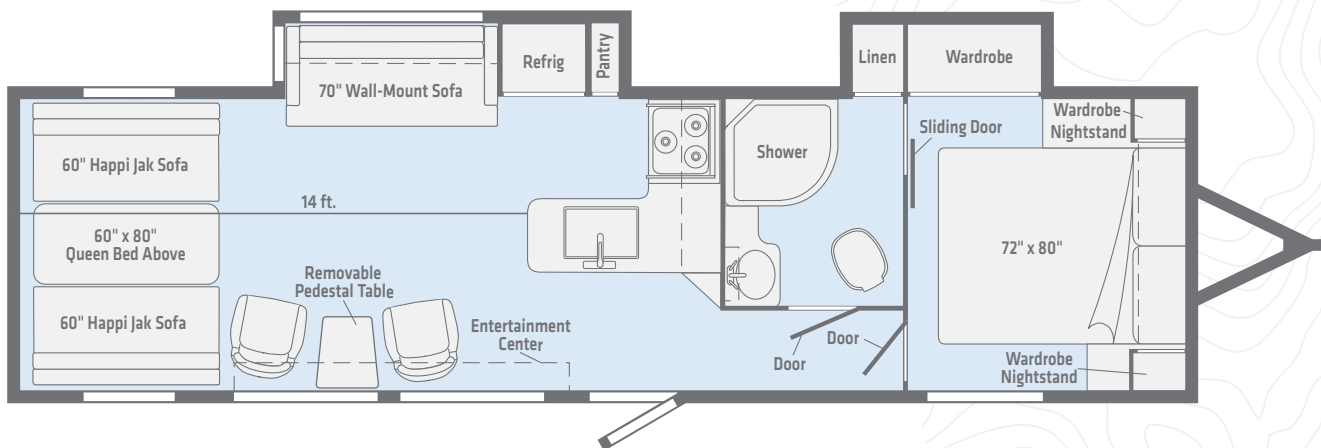

STANDARD FEATURES

- Decorative shades
- LED ceiling lights
- Digital TV antenna
- Upgraded AV system w/AM/FM/CD/DVD/USB & Bluetooth®
- Upgraded interior speakers
- All in One Systems Control Panel
- 43" LED TV in living room
- Microwave
- Recessed 3 burner range w/ oven & glass range cover
- Large sink w/sink covers
- 8 cu. ft. refrigerator
- Solid surface countertops
- Ceramic foot flush toilet
- Shower skylight
- Tub surround
- Large wood medicine cabinet
- 12V exhaust bath fan
- 72" x 80" RV king size mattress
- Bedroom roof vent
- Queen bed bunk
- Reading lights
- Noble Classic high gloss fiberglass sidewalls
- Black diamond plate rock shield
- Aluminum fender skirts
- Radial tires
- Dexter torsion axles
- 4 stabilizer jacks
- Undermount spare tire carrier
- Swing out door handle
- TPO roof
- Outside TV hook up
- Upgraded exterior speakers
- Hitch light
- Fold out solid entrance step
- Docking station
- 40-gallon fuel station
- Slam latch baggage doors
- 12V power awning w/ LED lighting
- Tinted windows
- Roof ladder (Retractable)
- 12V tongue jack
- Deluxe aluminum wheels
- Fiberglass front cap w/ LED lights
- Rear pull-down ramp patio screen
- 15K BTU ducted A/C
- 20# LP bottles w/bottle cover
- 4.0 Onan® generator
- Solar panel prep
- Enclosed and heated tanks
- 6-gallon water heater
- Black tank flush

OPTIONS

- 30# LP tank upgrade
- 200-watt solar kit
- 13.5K BTU 2nd A/C (50 amp required)
- 12V stabilizer jacks
- Goodyear tires
- TT leveling kit
- Stainless steel range
- Stainless steel range hood
- Stainless steel microwave
- 50 amp service w/ 2nd A/C prep
- 5.5K Onan Generator (50 amp required)
- 32" LED TV in bedroom
- Patio rail kit for ramp door
- Extreme Weather Package

SPECIFICATIONS

	Exterior Length (Ft) <i>(Pin To Rear Bumper)</i>	Exterior Height (Ft) <i>(Including A/C)</i>	Interior Height (Ft)	GVWR (Lbs)	Dry Weight (Lbs)	Dry Hitch Weight (Lbs)	Cargo Capacity (Wet)	Fresh Water (Tank Only) (Gal)	Black Tank Capacity (Gal)	Grey Tank Capacity (Gal)	LP Capacity (Lb)	Awning Length (Ft)	Furnace (Btu)	Water Heater (Gal)	Garage Length (Ft)	Fuel Tank Capacity (Gal)	Generator (Kw)
23FS	30'	12'6"	7'10"	9,995	7,500	860	TBD	100	50	50	40	18'	30,000	6	13' 11"	40	4.0 Std
28KS	35'10"	12'6"	7'10"	12,995	8,800	1,440	TBD	100	50	50	40	18'	30,000	6	14'	40	4.0 Std



Connect with other Spyder owners on the **Winnebago** Facebook page.



WIT
CLUB

www.witclub.com



Have a question about the Spyder?

Email SalesWOI@WGO.net.

WINNEBAGO

BOUND BY THE W

Winnebago of Indiana

201 14th Street, P.O. Box 2001
Middlebury, IN 46540 (574) 825-5250

www.winnebagoind.com

Your Winnebago Dealer

