

**Coachmen**  
Life should be so easy.

COA-10 06.07 Printed in USA  
to your purchase decision.  
design or specifications that are material  
constitute with your Coachmen dealer and  
shown in this brochure. Therefore, please  
new models and the discontinuance of models  
and specifications, as well as the addition of  
changes in price, color, materials, equipment  
and changes without notice, including  
Coachmen reserves the right to make all  
it may be necessary during the model year.  
publication. However, during the time of  
is believed to be accurate at the time of

**Coachmen Recreational Vehicle Company, LLC**  
P.O. Box 30, Middlebury, IN 46540

When you go RVing, there's one thing you should always leave behind: worry.  
At Coachmen, our **no hassle warranty** is our commitment to you, to assure your ongoing satisfaction. This no hassle warranty means that we won't refer you back to some supplier you've never heard of. We won't bounce you back and forth between the dealership and the factory. Our dealers are authorized to solve your problems on site and get you on your way without fuss, hassle or red tape. Also, should you ever need service or repair, it's easy to find one of the hundreds of Coachmen dealers or authorized repair centers nationwide.  
We take pride in working with Coachmen. You couldn't ask for with you every step of the way. Information on demand. We're dealer locations and other helpful information, visit [www.easyRVing.com](http://www.easyRVing.com) or call 1.800.353.7383.

**Easy to Enjoy. Honest.**

Pete, the Coachmen mascot, symbolizes our commitment to being your best friend on the road. Like Pete, we're always there to make sure everything about your Coachmen is as easy and uncomplicated as possible, so you can escape from the hassles and worries of everyday life and enjoy RVing.

**Easy to Use. Really.**

Your Coachmen will be easy to buy, easy to use and easy to maintain. That's our promise to you. We accomplish this in big ways through clever designs and superior support after the sale. But the real measure of being "easy" is in the count-include throughout your new service representative as well as access to warranty coverage information, maintenance information, troubleshooting tips, dealer locations and other helpful information on demand. We're proud to work with Coachmen. You couldn't ask for more.

AT COACHMEN, we're all about easy. Our motorhomes, fifth wheels, travel trailers and folding campers are designed to be easy to use, easy to enjoy, easy to own. And our no hassle warranty keeps them that way.

Coachmen



To see how Coachmen is making the easy life even easier, visit [www.easyRVing.com](http://www.easyRVing.com) or call 1.800.353.7383.

COACHMEN | 2008 FREELANDER CLASS C MOTORHOMES



**= Easy Feature**  
Coachmen RV. As you review this brochure please check out Pete's paw print symbols that indicate many of our easy touches. Remember, no matter where the road takes you, the going is always easier with Coachmen.

**Easy.**  
Step Into the Easy Life.  
2008 Coachmen Frelander™



**Coachmen**  
Life should be so easy.



Frelander™



**It's Easy.**

Whether you've outgrown your tent camper or you're just ready to explore the motorhome lifestyle, the easy life begins with the Coachmen Frelander. Stylish, roomy and affordable, Frelander has everything you and your family need to enjoy the great outdoors in comfort and convenience. What's more, Frelander has tons of storage space, so you can take all your gear wherever the road leads you. And Frelander is backed up by Coachmen's no hassle warranty and a nationwide network of service centers.

Ready for adventure? It's as close as your nearest Coachmen dealer!



The unique Frelander Fast Lane (3130IS) is the perfect motorhome for the family on the go. From tailgating to enjoying an evening with the family, the huge sofa lounge, island countertop and marine style stools make it easy for everyone to join in on the fun. (Shown in Windsor Wine decor)



Frelander Class C Motorhomes

**Features that matter.**



**EASY CONVENIENCES**  
Frelander makes it easy to take it all with you. The huge exterior compartments have more than 100 cubic feet of storage space (most models) while the industry-leading 56-gallon fresh water system allows you to enjoy the great outdoors even longer.

Fresh Water System	
Frelander 56 Gallons	Other Brands 41 Gallons



**EASY RESTING**  
Frelander accommodates the whole family in comfort for an easy night's sleep. Most models have residential-size queen beds (not the short variety usually found in RVs), a roomy bunk over the cab and on some models an easy-to-convert hide-a-bed sofa.



The surprisingly spacious 2130QB provides ample seating in the U-dinette booth as well as plenty of sleeping space, so the whole family can relax in comfort.



Visit our website anytime at [www.easyRVing.com](http://www.easyRVing.com) for more information, and easy shopping tools like



- Finding the right Coachmen for you.
- Comparing different Coachmen models.
- Building your own RV.



# 2008 Coachmen Frelander™ Easy.

Step Into the Easy Life.

The spacious and inviting interior of the 3150SS features an extra-high 6'10" ceiling, hardwood edge countertops, high-spout faucet, raised panel cabinet doors, designer window treatments and pleated window shades.



## Decor Choices

**FABRIC KEY**  
A. Main B. Accent

Coachmen's dazzling interiors feature top-grade fabrics that have been tested for maximum durability.

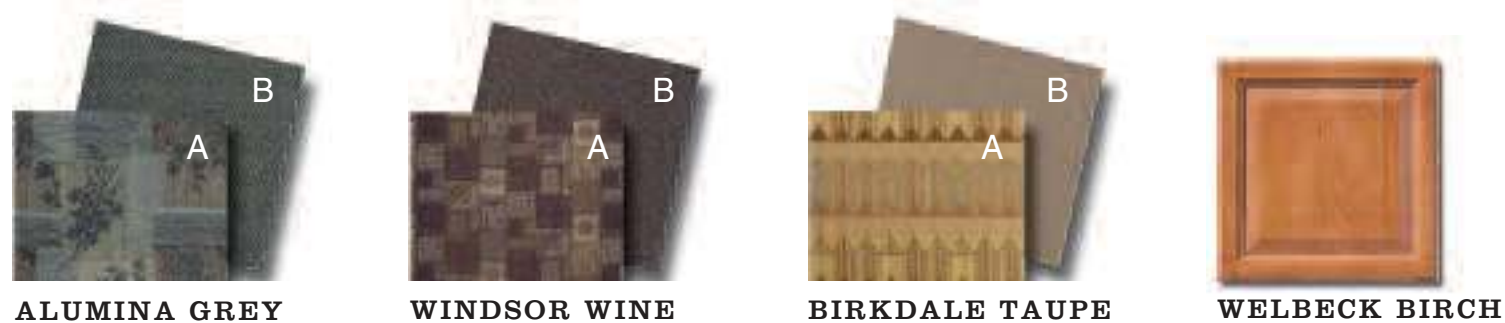

ALUMINA GREY WINDSOR WINE BIRKDALE TAUPE WELBECK BIRCH

## Easy Features

NS		SS		NS		SS		NS		SS	
<b>LIVING APPOINTMENTS</b>											
Linoleum flooring throughout	S	-	-	-	-	Outside 120-volt receptacle	S	S	Laminated floor	S	S
Linoleum flooring (kitchen and bath)	-	S	-	-	-	Cable TV jacks	S	S	Laminated sidewalls	S	S
Carpet (living and bedroom)	-	S	-	-	-	Patio light	S	S	Laminated crowned roof	S	S
Pleated window shades throughout	-	S	-	-	-	4000 series Generac® gas generator	S	S	TPO roof covering	S	S
Hide-a-bed sofa** (n/a 2600SO)	-	S	-	-	-	4000 series Generac® lp generator (diesel units only)	S	S	Roof ladder	S	S
Comfort lounge sofa (n/a 2130QB)	S	-	-	-	-	Coach command center	S	S	Aluminum running boards	S	S
U-shaped dinette/lounge (2890QB booth dinette)	S	-	-	-	-	Electric heated holding tanks*	S	S	Powered entrance step	O	O
Booth dinette (n/a 3130IS)	-	S	-	-	-	<b>PLUMBING AND LP SYSTEM</b>	-	-	Patio awning	O	O
Booth dinette (n/a 3130IS)	-	S	-	-	-	Duratube™ copper LP lines	S	S	Slideroom awnings	-	-
Skylight in living area	-	S	-	-	-	Water heater by-pass valve	S	S	Slick exterior sidewall material	S	O
High spout kitchen faucet	S	S	-	-	-	6-gallon gas E.I. water heater	S	-	Cabover window	S	O
<b>SLEEPING APPOINTMENTS</b>											
Residential queen bed — 60" x 80" (n/a 2230RK)	S	S	-	-	-	6-gallon gas/electric E.I. water heater	S	-	CSA Upfit	O	O
Cabover queen bed — 57" x 95"	S	S	-	-	-	Demand water pump	S	S	<b>SAFETY AND SECURITY</b>	-	-
Privacy drape — cabover bed	S	S	-	-	-	Exterior wash station	-	S	LP leak alarm	S	S
Privacy drape — cockpit area	S	S	-	-	-	Skylight over shower	S	S	Fire extinguisher	S	S
Double bunk beds in place of queen bed*** (2890QB and 3150SS only)	O	O	-	-	-	Glass shower enclosure (2890QB and SS models)	S	S	Smoke detector	S	S
<b>COCKPIT APPOINTMENTS</b>											
Cruise control	S	S	-	-	-	Shower curtain (n/a 2890QB)	S	-	Emergency start switch	S	S
Tilt steering wheel	S	S	-	-	-	One-piece ABS tub surround	S	S	Driver and passenger air bags	S	S
Power windows and locks	S	S	-	-	-	<b>EXTERIOR AND CONSTRUCTION</b>	-	-	Exterior security light*	-	-
Dash air conditioning	S	S	-	-	-	6.0L diesel engine — Ford (2890QB and 2600SO only)	O	O	Entrance door dead bolt lock	-	-
Dash stereo with CD player	S	-	-	-	-	5,000 lb. towing hitch	S	S	Safety glass windows	S	-
Dash stereo with CD player, weather band and satellite radio capable	-	S	-	-	-	Metal wheel covers	-	S	Tinted safety glass windows	-	S
Reclining 2-tone captains chairs	S	S	-	-	-	Stainless steel wheel inserts	O	O	Owners information package	-	S
						Spare tire kit (n/a 3130IS)	S	S			
						Air assist suspension	O	O			

**Easy Feature**  
S = Standard O = Optional  
NS = Non-Slide Models SS = SuperSlide Models  
\*Not available in units shipped to Canada.  
\*\*Hide-a-bed not available on 3150SS when equipped with bunk option.  
\*\*\*Chevy models equipped with rear bunk option have a reduced fresh water capacity of 25 gallons.

## Non-Slide Models

SPECIFICATIONS	2130QB	2230RK	2890QB	2600SO	3130IS	3150SS
Chassis	Chevy	Chevy	Chevy/Ford	Ford	Ford	Ford
Chassis model	C-3500	C-3500	C-3500/E-45	E-45	E-45	E-45
Engine size (liter)	6.0L	6.0L	6.0L/6.8L	6.8L	6.8L	6.8L
Wheel base	159"	177"	191"	176"	208"	208"
Rear axle ratio	4.1	4.1	4.1/4.56	4.56	4.56	4.56
GVWR (lbs.)	12,300	12,300	12,300/14,050	14,050	14,050	14,050
CW (lbs.)	8,972	9,038	9,674/10,903	11,061	12,350	11,995
GAWR front (lbs.)	4,300	4,300	4,300/4,600	4,600	4,600	4,600
GAWR rear (lbs.)	8,600	8,600	8,600/9,450	9,450	9,450	9,450
GCWR (lbs.)	16,000	16,000	16,000/20,000	20,000	20,000	20,000
Exterior length	23'8"	24'6"	30'4"/29'10"	27'8"	31'11"	31'11"
Exterior height (including A/C)	11'2"	11'2"	11'2"	11'2"	11'2"	11'2"
Exterior width	8'4"	8'4"	8'4"	8'4"	8'4"	8'4"
Exterior storage capacity (cu. ft.)	102	38	55	112	104	113
Sleeping capacity	5	4	6	5	5	6
Interior width	8'	8'	8'	8'	8'	8'
Interior height	6'10-1/2"	6'10-1/2"	6'10-1/2"	6'10-1/2"	6'10-1/2"	6'10-1/2"
Fuel capacity (gal.)	35	35	35/55	55	55	55
Fresh water capacity (gal.)	50	50	50	50	50	50
Grey water capacity (gal.)	37	28	27	29	28	28
Waste water capacity (gal.)	22	28	27	29	27	27
LP gas capacity (lbs.)	40	40	40	68	68	68
Tire size	16"	16"	16"	16"	16"	16"

## SuperSlide Models

**GVWR** (Gross Vehicle Weight Rating): The Maximum permissible weight of the unit, including the U/V plus all fluids, cargo, optional equipment and accessories. For safety and product performance, do not exceed the GVWR.

**CW** (Curb Weight): The weight of the unit without factory or dealer installed options, plus allowance for the weight of full fuel capacity. The "payload capacity" for all other fluids, cargo, occupants, optional equipment, and accessories can be determined by subtracting the CW from the GVWR.

**GAWR** (Gross Axle Weight Rating): The total weight of each front/rear axle, suspension and tire system is designed to carry. When loading the unit, care should be taken to balance cargo weight in consideration of the GAWRs.

**GCWR** (Gross Combined Weight Rating): The maximum total weight of the loaded unit, plus a tow vehicle. This includes the weight of both the unit and tow vehicle, fuel for each, all other fluids, cargo, occupants, optional equipment and accessories.

**Wider Widths:** Numerous Coachmen floorplans feature the "wide body" design concept, which gives you significantly enhanced interior living space and innovative floorplans.

In making your purchase decision, you should be aware that a few states restrict access on some or all roads within the state to vehicle with a maximum 96" width, although special road usage permits may be available. Vehicles up to 102" in some width are permitted in the vast majority of states. You should confirm the road usage laws in the states of interest to you before making your purchase decision. If width is of concern to you, we invite you to consider the broad array of other Coachmen models offers in the standard 96" width.

**Important Note:** All capacities are approximate, and all dimensions are nominal. Coachmen motorhomes are designed to allow for a wide variety of uses, extended trips with two people or short trips with multiple people. Accordingly, each unit allows ample room for sleeping, seating, fluids and cargo. While the customer is the beneficiary of this design, the customer also bears the responsibility to select the proper combination of passengers, cargo, load, and tow vehicle without exceeding the chassis weight capabilities. Consumer may need additional braking capacity to tow loads greater than 1,000 pounds.

Seat belt should always be worn for passenger safety. Seat belts are provided at most locations to allow convenience in selecting which seat to occupy. However, it is not intended that all seating positions equipped with a seat belt may be occupied while the vehicle is in motion, without regard to other weight factors.

All Coachmen motorhomes are designed to ensure that the number of passengers allowed while the vehicle is in motion will always at least equal the stated sleeping capacity. Through extra seat belts may be provided, for your safety and the proper operation of your vehicle, limit your passengers to the number allowed by the Net Carrying Capacity of your vehicle.



Frelander, Non-Slide Models – Easy Living Floorplans



Frelander, SuperSlide Models – Easy Living Floorplans

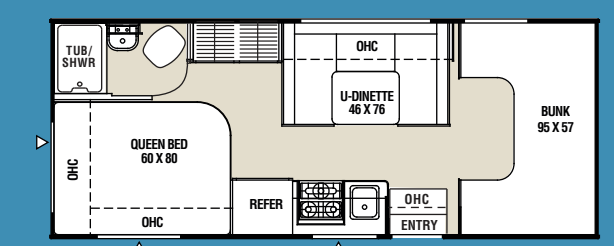

2130QB | Exterior Storage: 102 cu. ft. | Sleeps 5

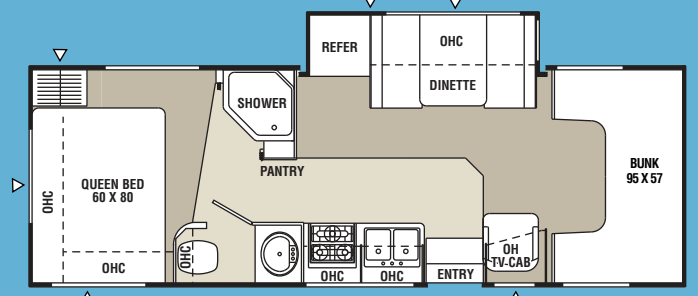

2600SO | Exterior Storage: 112 cu. ft. | Sleeps 5

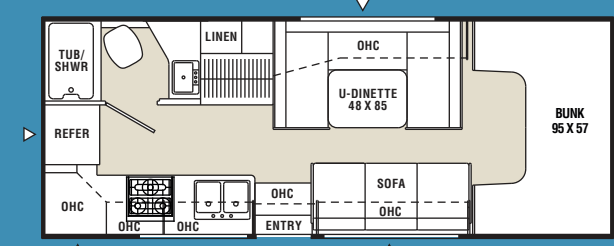

2230RK | Exterior Storage: 38 cu. ft. | Sleeps 4

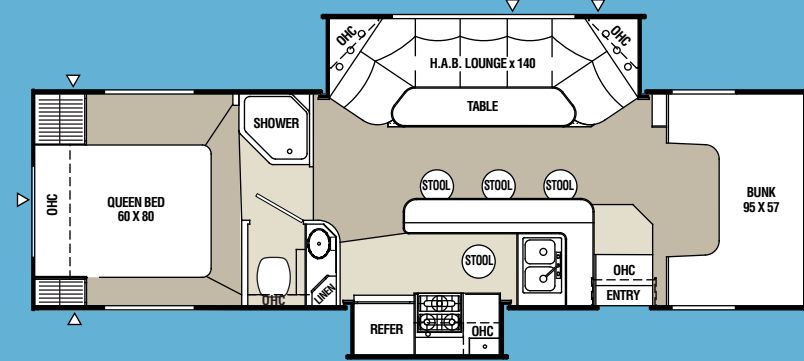

FAST LANE 3130IS | Exterior Storage: 104 cu. ft. | Sleeps 5

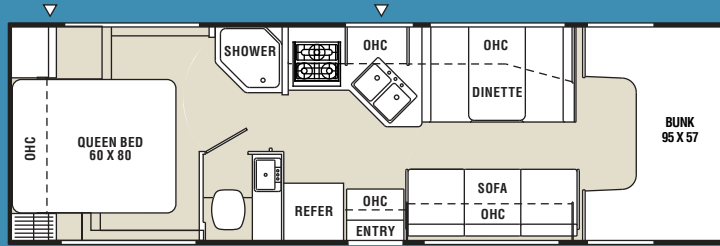

2890QB | Exterior Storage: 55 cu. ft. | Sleeps 6

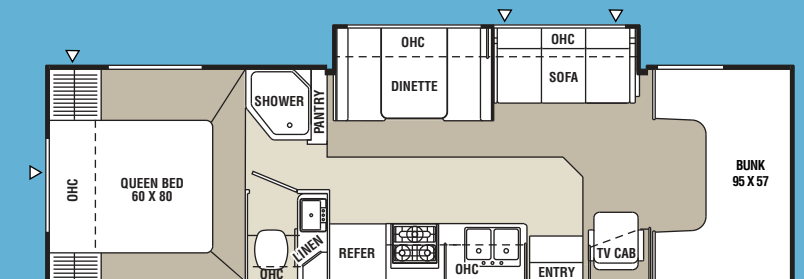

3150SS | Exterior Storage: 113 cu. ft. | Sleeps 6

▲ Outside Storage Location  
■ Linoleum

▲ Outside Storage Location  
■ Carpet  
■ Linoleum

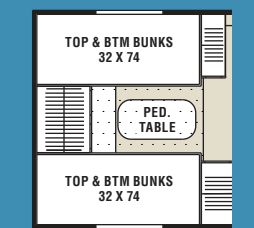

Bunk Option Available on 2890QB

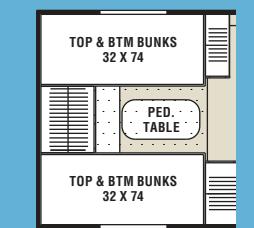

Bunk Option Available on 3150SS

## Frelander – Easy Exterior Features



- Roof Ladder
- TPO Roof Covering
- High Gloss Exterior Sidewalls
- Tinted Windows (Slide Models)
- 5,000 lb. Tow Hitch
- Raised Departure Angle
- Firestone Ride Rite® Air Assist Suspension (Optional)
- Upgraded Exterior Mirrors



Automotive style dash is loaded with conveniences like power windows and locks, cruise control, power steering, drink holders, dual air bags and dash stereo CD player that make driving simple and easy.



Coach command center makes it simple to use many of the commonly used gauges and switches.



Optional overhead entertainment center includes a 26" LCD TV, DVD player and a Bose® Wave radio sound system. It loads the Frelander with fun for the whole family while still allowing room for a bunk that can sleep a full-size adult.



The standard ceiling skylight makes the living area lighter and brighter (SuperSlide Models).